

**Material**

Screw: M3.0, Steel,Zn plated  
 Shrapnel: Phosphor Bronze ,Nickel plated  
 Pin header: Brass , Tin plated  
 Housing: PA66, UL94V-0

**Electrical**

Rated voltage:250V  
 Rated current: 16A  
 Wire range:22~14AWG 2.5mm<sup>2</sup>  
 Contact Resistance: 20 mΩ  
 Insulation resistance: 500MΩ/DC500V  
 Withstand voltage: AC2000V/1min

**Mechanical**

Temp.Range: -40℃~+105℃  
 Soldering: 250℃ 5Sec. Max  
 Torque: 0.5 N.m (4.43Lb. in)  
 Strip length: 4.5~5mm

**Order Information**

RHTBY00 -7.50 -XXP -2 S XX

Terminal Block

Pitch

No. of Pole

Product Cde:00~99

Screw:S-Slot Screw

Color:2-Blue

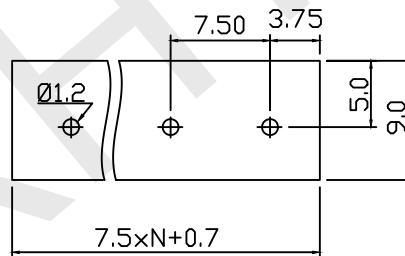
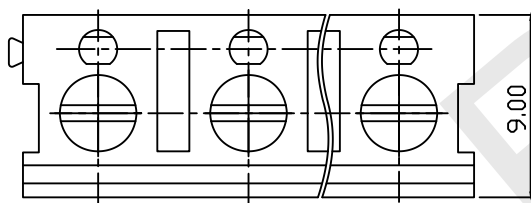

PCB LAYOUT

**RHTECP** NINGBO RHT ELECTRONIC CO.,LTD

UNITS:mm	SHEET SIZE: A4			SCALE:---	DRWN BY PAN
0~3	3~18	18~50	50~120	CHK'D BY FENG	
±0.12	±0.15	±0.3	±0.5	APPR BY ZHAN	

Screw Conn Term Block 7.50mm

THIRD ANGLE PROJECTION

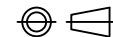

RHTBY00-7.50-XXP-2S