



## QUARTZ CRYSTAL RESONATOR

### PARAMETERS

RHTNYC-3225

Nominal frequency range: 10.000~54.000 MHZ , 54.000~125.000 MHZ

Crystal cut: Fundamental [AT-cut], 3rd overtone [AT-cut]

Storage temperature range: -40°C~+85°C

Operating temperature range: -10°C~+60°C, -30°C~+85°C

Frequency temperature characteristics(Ref. to +25°C):  $\pm 10 \times 10^{-6}$   $\pm 15 \times 10^{-6}$

Frequency tolerance (at +25°C):  $\pm 10 \times 10^{-6}$

Equivalent series resistance: Please Refer to the Following ESR Table

Load capacitance: Series, 10pF, 12pF, 16pF

Shunt capacitance: 5pF max.

Level of drive: 10  $\mu$ W (100  $\mu$ W max.)



### Outline and Dimensions [unit:mm]

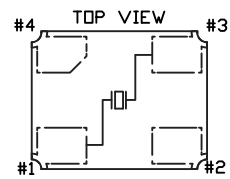
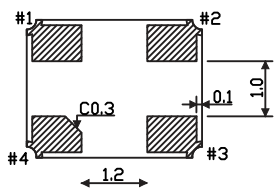
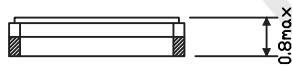
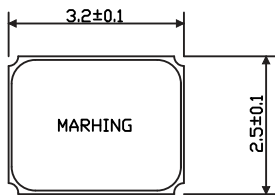

#1,#3:Crystal terminal  
#2,#4:Connected to cover  
(Please connect it with GND)

Example of a Terminal Land Pattern

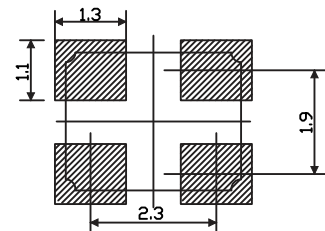

Frequency	ESR( $\Omega$ )
Fundamental	
10.000~15.999	100
16.000~18.999	80
19.000~29.999	60
30.000~54.000	40
3rd overtone	
54.000~125.000	100

### ORDER INFORMATION

