

Material

Housing:PA66,UL94V-0

Pin header:Brass, Tin plated

Nut:M2.5 Brass

Electrical

Rated voltage:300V

Rated current:15A

Contact Resistance:20 mΩ

Insulation resistance:500MΩ/DC500V

Withstand voltage:AC2000V/1min

Mechanical

Temp.Range:-40℃~+105℃

Order Information

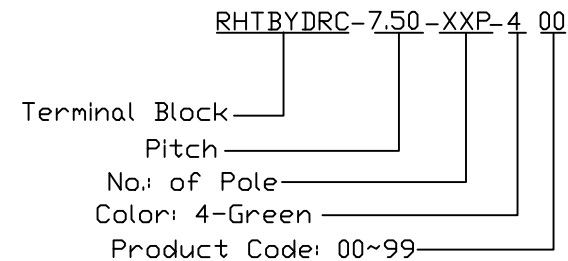

**RHTECP** NINGBO RHT ELECTRONIC CO.,LTD

UNITS:mm	SHEET SIZE: A4				SCALE:---	DRWN BY PAN
0~3	3~18	18~50	50~120	CHK'D BY FENG	THIRD ANGLE PROJECTION	
±0.12	±0.15	±0.3	±0.5	APPR BY ZHAN	RHTBYDRC-7.50-XXP-4-00	

Pluggable Terminal Block 7.50MM

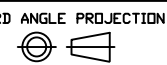

RHTBYDRC-7.50-XXP-4-00

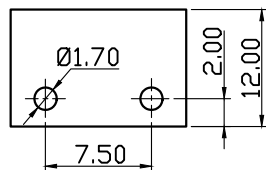
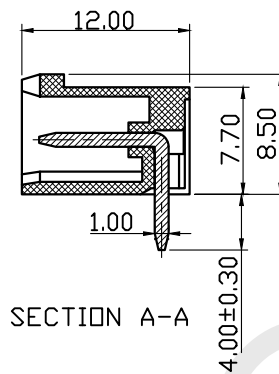
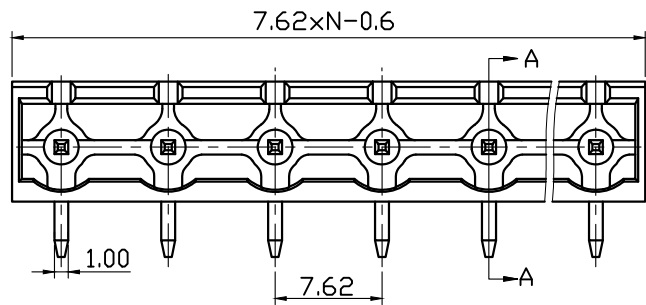

Material

Housing:PA66,UL94V-0

Pin header:Brass, Tin plated

Nut:M2.5 Brass

Electrical

Rated voltage:300V

Rated current:15A

Contact Resistance:20 mΩ

Insulation resistance:500MΩ/DC500V

Withstand voltage:AC2000V/1min

Mechanical

Temp.Range:-40℃~+105℃

Order Information

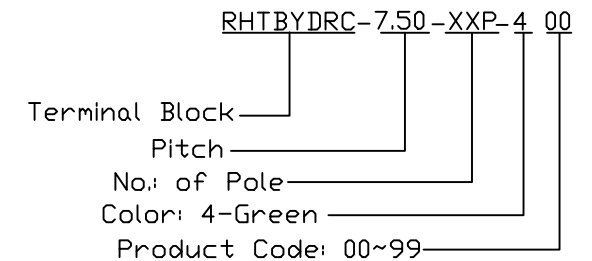

**RHTECP** NINGBO RHT ELECTRONIC CO.,LTD

UNITS:mm	SHEET SIZE: A4				SCALE:---	DRWN BY PAN
0~3	3~18	18~50	50~120	CHK'D BY FENG	THIRD ANGLE PROJECTION	
±0.12	±0.15	±0.3	±0.5	APPR BY ZHAN	RHTBYDRC-7.50-XXP-4-00	

Pluggable Terminal Block 7.50MM

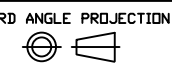

RHTBYDRC-7.50-XXP-4-00