

RoHS Compliance

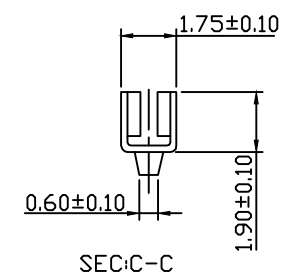
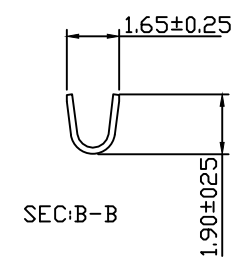
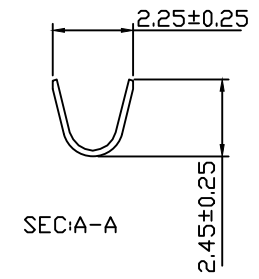
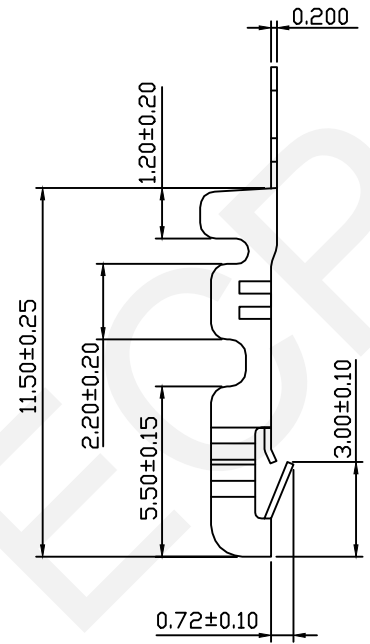
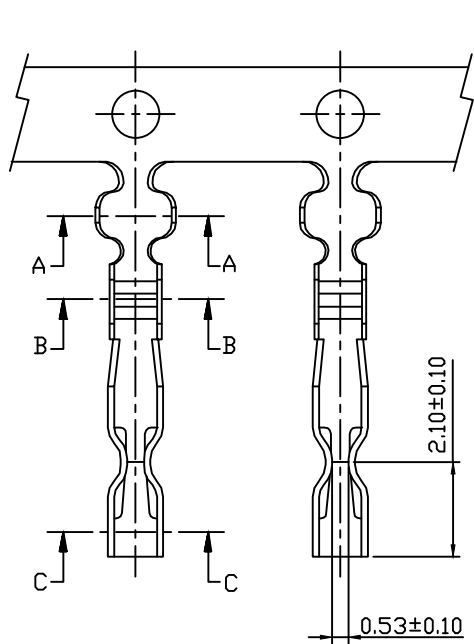

Ordering Information & Specifications

Part No.	Wire Range	Insulation ϕ .D	Material	Finish	Qty/Reel
2.50-T	AWG#20-#26	1.90mm(max)	Brass	Tin-Plated	10000PCS

Note: E-Stamping-Before Tin-Plated

Order Information

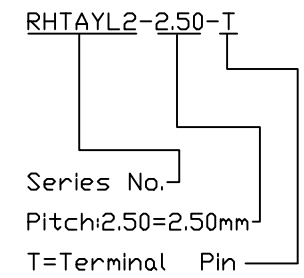

A
B
C
D
E
F
G

A
B
C
D
E
F
G



NINGBO RHT ELECTRONIC CO.,LTD

UNITS:mm	SHEET SIZE: A4				SCALE:---	DRWN BY PAN
0~3	3~18	18~50	50~120			CHK'D BY FENG
±0.12	±0.15	±0.3	±0.5			APPR BY ZHAN

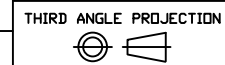

2.50mm 171822 Type
Wire To Board Connector

RHTAYL2-2.50-T

1 2 3 4 5 6 7 8 9

RoHS Compliance

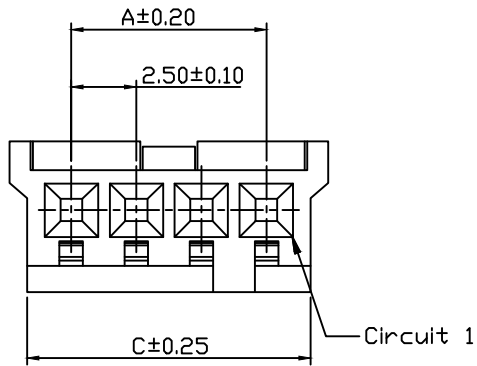

Ordering Information&Dimensions

Part No.	Dimension(mm)		
	A	B	C
02	2.50	7.25	5.90
03	5.00	9.75	8.40
04	7.50	12.25	10.90
05	10.00	14.75	13.40
06	12.50	17.25	15.90
07	15.00	19.75	18.40
08	17.50	22.25	20.90
09	20.00	24.75	23.40
10	22.50	27.25	25.90
11	25.00	29.75	28.40
12	27.50	32.25	30.90
13	30.00	34.75	33.40
14	32.50	37.25	35.90
15	35.00	39.75	38.40

Material:

Housing: Nylon 66, UL94V-0

COLOR: Natural(White)

Electrical Characteristics:

Poles: 2 To 15P

Voltage Rating : 250V

Current Rating : 3.0A

Insulator Resistance: 500MΩ/Min.

Contact Resistance: 10MΩ/Max

Withstand Voltage: 800V AC/Minute

Working Temperature : -25°C To +85°C

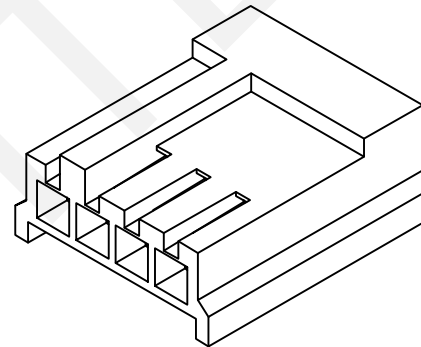
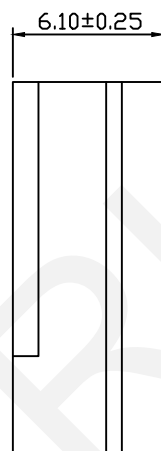
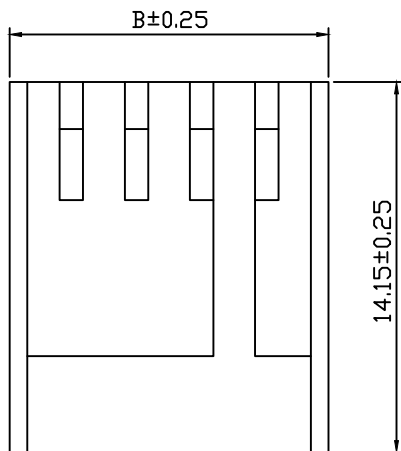

Order Information

RHTAYL2-2.50-XX-H

Series No. |

Pitch: 2.50=2.50mm |

PIN Number: 02~15Pin |

H=Hosing |

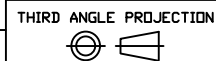

2.50mm 171822 Type
Wire To Board Connector

RHTAYL2-2.50-XX-H

RHTECP NINGBO RHT ELECTRONIC CO.,LTD

UNITS:mm	SHEET SIZE: A4	SCALE:---	DRWN BY PAN
0~3	3~18	18~50	50~120
±0.12	±0.15	±0.3	±0.5
CHK'D BY FENG		APPR BY ZHAN	

1

2

3

4

5

6

7

8

9

RoHS Compliance

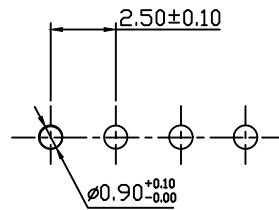
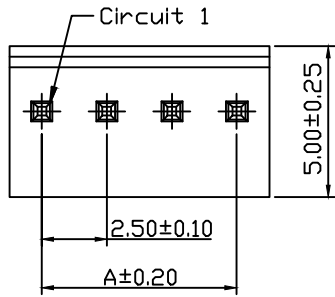

PCB Layout

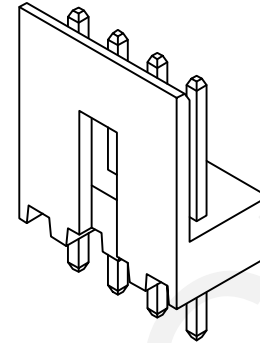

Material:
Housing: Nylon 66, UL94V-0(White)
Contacts: Brass Tin-Plated

Electrical Characteristics:
Poles: 2 To 15P

Voltage Rating : 250V
Current Rating : 3.0A
Insulator Resistance: 500MΩ/Min.
Contact Resistance: 10MΩ/Max
Withstand Voltage: 800V AC/Minute
Working Temperature :-25°C To +85°C

Ordering Information&Dimensions

Part No.	Dimension(mm)	
	A	B
02	2.50	5.00
03	5.00	7.50
04	7.50	10.00
05	10.00	12.50
06	12.50	15.00
07	15.00	17.50
08	17.50	20.00
09	20.00	22.50
10	22.50	25.00
11	25.00	27.50
12	27.50	30.00
13	30.00	32.50
14	32.50	35.00
15	35.00	37.50

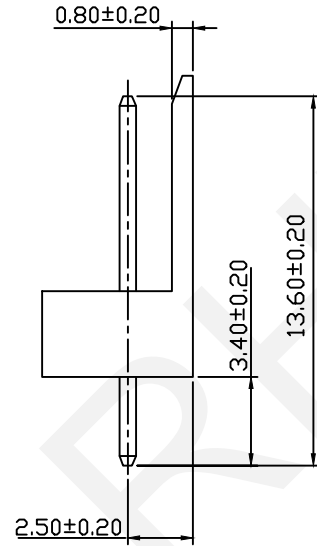
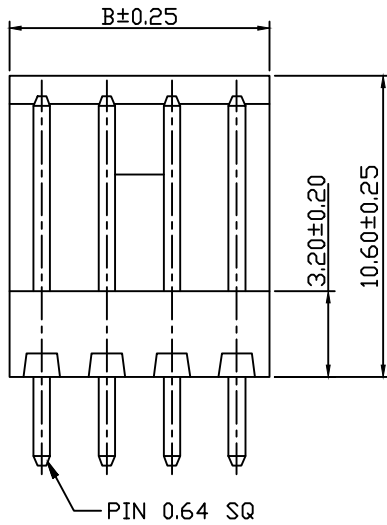

Order Information

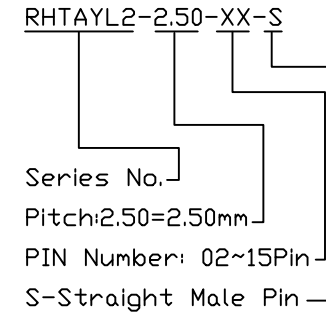

RHTECP NINGBO RHT ELECTRONIC CO.,LTD

UNITS:mm SHEET SIZE: A4 SCALE:---
0~3 3~18 18~50 50~120
±0.12 ±0.15 ±0.3 ±0.5

DRWN BY PAN
CHK'D BY FENG
APPR BY ZHAN

2.50mm 171822 Type
Wire To Board Connector
THIRD ANGLE PROJECTION
RHTAYL2-2.50-XX-S

RoHS Compliance

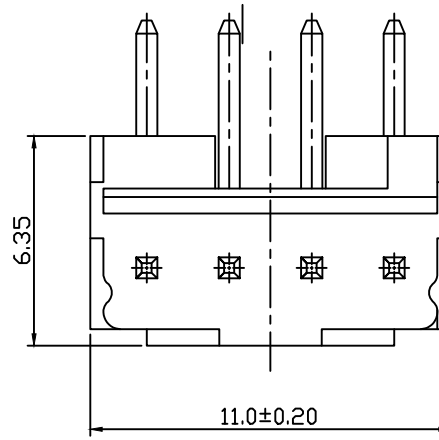

Material:
Housing:PA66 UL94V-0
Contacts:Brass

Electrical Characteristics:
Poles:2 To 20P
Voltage Rating : 250V
Current Rating : 3.0A
Insulator Resistance: 1000MΩ/Min.
Contact Resistance: 0.02MΩ/Max
Withstand Voltage: 1000V AC/Minute
Working Temperature :-25°C To +85°C
Applicable Wire:AWG #22 to #28

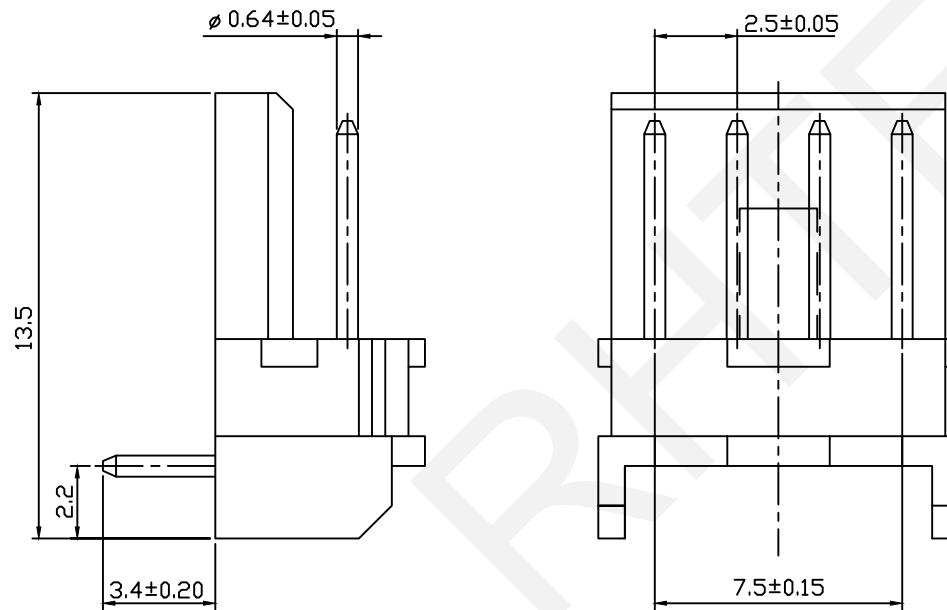

Order Information
RHTAYL2-2.50-XX-R

Series No. -
Pitch:2.50=2.50mm -
PIN Number:02~20Pin -
R=Right Angle Male Pin -

RHTECP NINGBO RHT ELECTRONIC CO.,LTD

UNITS:mm	SHEET SIZE: A4	SCALE:---	DRWN BY PAN
0~3	3~18	18~50	50~120
±0.12	±0.15	±0.3	±0.5

CHK'D BY FENG
APPR BY ZHAN

2.50mm 171822 Type
Wire To Board Connector
THIRD ANGLE PROJECTION
RHTAYL2-2.50-XX-R

RoHS Compliance

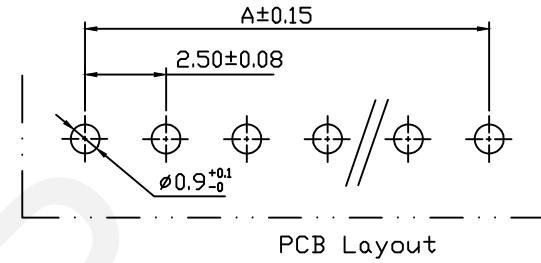
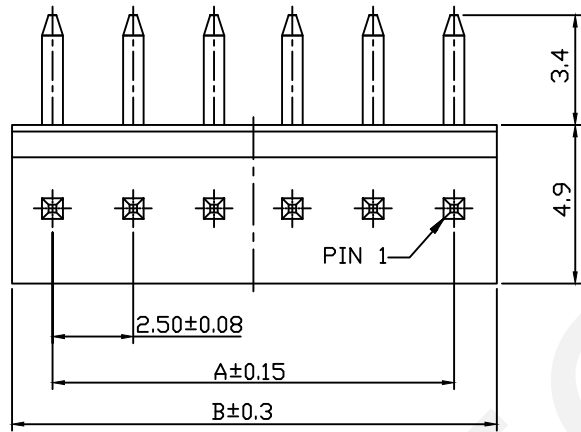

Part No.	DIM A	DIM B
02	2.5	5.0
03	5.0	7.5
04	7.5	10.0
05	10.0	12.5
06	12.5	15.0
07	15.0	17.5
08	17.5	20.0
09	20.0	22.5
10	22.5	25.0
11	25.0	27.5
12	27.5	30.0



Material:
Housing: Nylon 66 UL94V-0 Contacts: Brass

Electrical Characteristics:
Poles: 2 To 12P
Voltage Rating: 250V Current Rating: 2.0A
Insulator Resistance: 1000M Ω /Min.
Contact Resistance: 20M Ω /Max
Withstand Voltage: 800V AC/Minute
Working Temperature: -25°C To +95°C
Applicable Wire: AWG #20 to #26

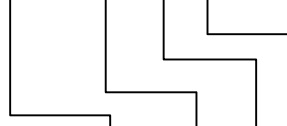
Order Information
RHTAYL2-2.50-XX-R1

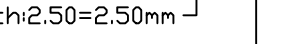
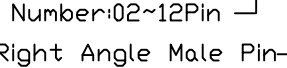
Series No. 
Pitch: 2.50=2.50mm 
PIN Number: 02~12Pin 
R1=Right Angle Male Pin 

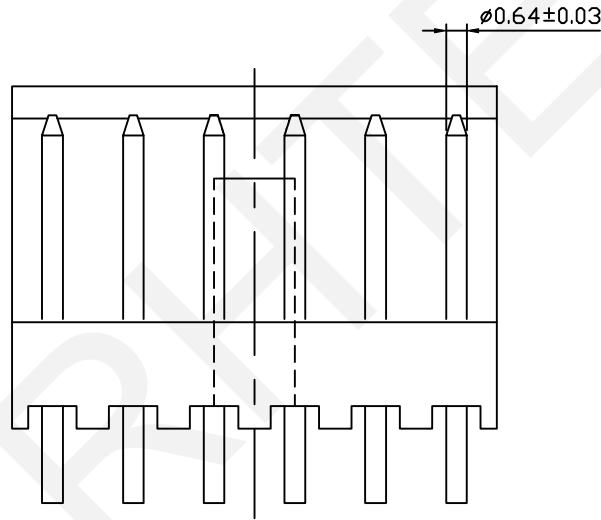
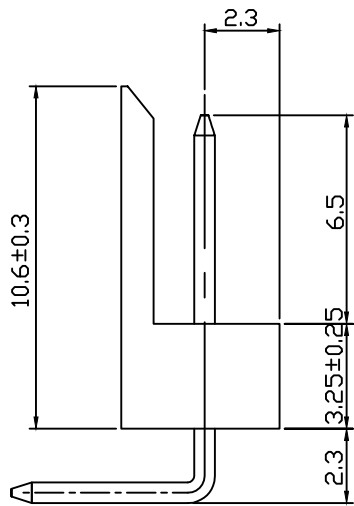

 NINGBO RHT ELECTRONIC CO.,LTD

UNITS:mm	SHEET SIZE: A4		SCALE:---	DRWN BY PAN
0~3	3~18	18~50	50~120	CHK'D BY FENG
±0.12	±0.15	±0.3	±0.5	APPR BY ZHAN

2.50mm 171822 Type
Wire To Board Connector
THIRD ANGLE PROJECTION
 RHTAYL2-2.50-XX-R1