

RoHS Compliance

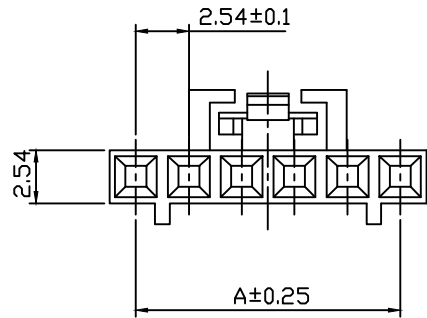

| Pin | Dimension(mm) | |
|-----|---------------|-------|
| | A | B |
| 02 | 2.54 | 5.08 |
| 03 | 5.08 | 7.62 |
| 04 | 7.62 | 10.16 |
| 05 | 10.16 | 12.70 |
| 06 | 12.70 | 15.24 |
| 07 | 15.24 | 17.78 |
| 08 | 17.78 | 20.32 |
| 09 | 20.32 | 22.86 |
| 10 | 22.86 | 25.40 |
| 11 | 25.40 | 27.94 |
| 12 | 27.94 | 30.48 |
| 13 | 30.48 | 32.02 |
| 14 | 32.02 | 35.56 |
| 15 | 35.56 | 38.10 |
| 16 | 38.10 | 40.64 |
| 17 | 40.64 | 43.18 |
| 18 | 43.18 | 45.72 |
| 19 | 45.72 | 48.26 |
| 20 | 48.26 | 50.80 |

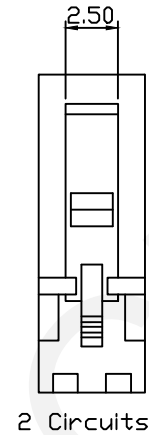

Material:
Housing:PA66 UL94V-0

Electrical Characteristics:
Rated Current : 3.0AMP
Voltage Rating : 250V AC,DC
Temperature Range: -25°C~+85°C
Insulator Resistance: 1000MΩ/Min.
Withstand Voltage: 600V AC/Minute
Contact Resistance: 20MΩ/Max

Order Information
RHTAYL2-2.54-XX-MH

Series No. _____
Pitch:2.54mm _____
XX-No.of 02~20Pins _____
Type: _____
MH/FH-Hosing MT/FT-Terminal
S-Straight Male Pin
R RW-Right Angle Male Pin
VM-Vertical SMT Pin
RM-Horizontal SMT Pin

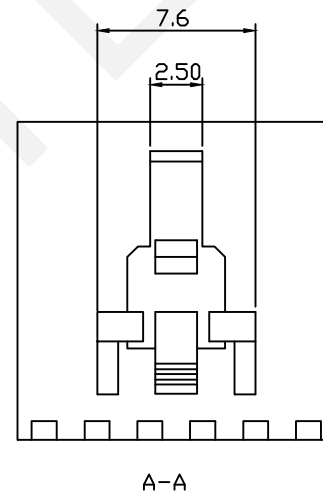
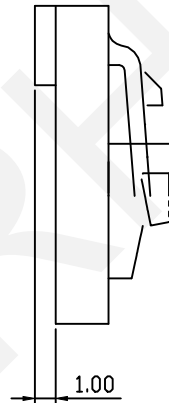
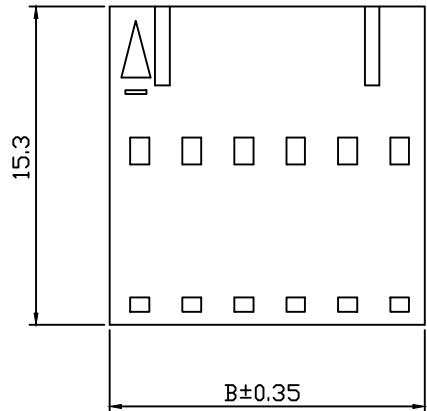

RHTECP NINGBO RHT ELECTRONIC CO.,LTD

| | | | |
|----------|----------------|-----------|---------------|
| UNITS:mm | SHEET SIZE: A4 | SCALE:--- | DRWN BY PAN |
| 0~3 | 3~18 | 18~50 | 50~120 |
| ±0.12 | ±0.15 | ±0.3 | ±0.5 |
| | | | CHK'D BY FENG |
| | | | APPR BY ZHAN |

2.54mm Pitch SL Modular
Wire To Board Connector
THIRD ANGLE PROJECTION
 RHTAYL2-2.54-XX-MH

RoHS Compliance

RIBS ON 8-25 CKT.ONLY

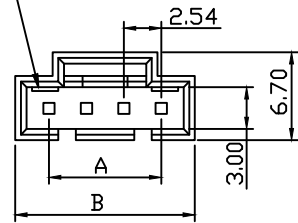

2 CIRCUIT

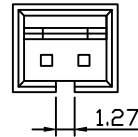

3 CIRCUIT

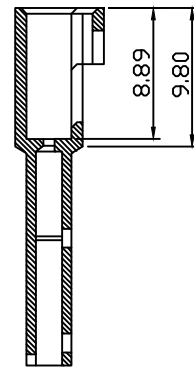
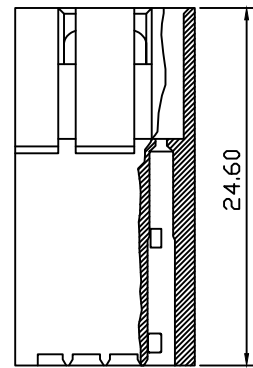
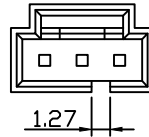

SECTION A-A

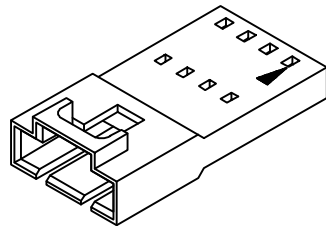
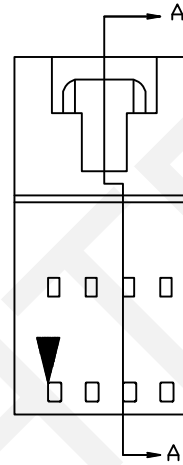

Material:
Housing:PA66 UL94V-0,Black

Electrical Characteristics:
Rated Current : 3.0AMP
Voltage Rating : 250V AC,DC
Temperature Range: -25°C~+85°C
Insulator Resistance: 1000MΩ/Min.
Withstand Voltage: 600V AC/Minute
Contact Resistance: 20MΩ/Max

| Pin | Dimension(mm) | |
|-----|---------------|-------|
| | A | B |
| 02 | 2.54 | 7.32 |
| 03 | 5.08 | 9.86 |
| 04 | 7.62 | 12.40 |
| 05 | 10.16 | 14.94 |
| 06 | 12.70 | 17.48 |
| 07 | 15.24 | 20.02 |
| 08 | 17.78 | 22.56 |
| 09 | 20.32 | 25.10 |
| 10 | 22.86 | 27.64 |
| 11 | 25.40 | 29.48 |
| 12 | 27.94 | 32.72 |
| 13 | 30.48 | 35.26 |
| 14 | 32.02 | 37.80 |
| 15 | 35.56 | 40.34 |
| 16 | 38.10 | 42.88 |
| 17 | 40.64 | 45.42 |
| 18 | 43.18 | 47.96 |
| 19 | 45.72 | 50.50 |
| 20 | 48.26 | 53.04 |

Order Information
RHTAYL2-2.54-XX-FH

Series No. _____
Pitch:2.54mm _____
XX-No.of 02~20Pins _____
Type: _____

MH/FH-Hosing MT/FT-Terminal
S-Straight Male Pin
R RW-Right Angle Male Pin
VM-Vertical SMT Pin
RM-Horizontal SMT Pin

RHTECP NINGBO RHT ELECTRONIC CO.,LTD

| | | | | | |
|----------|----------------|-------|--------|---------------|-------------|
| UNITS:mm | SHEET SIZE: A4 | | | SCALE:--- | DRWN BY PAN |
| 0~3 | 3~18 | 18~50 | 50~120 | CHK'D BY FENG | |
| ±0.12 | ±0.15 | ±0.3 | ±0.5 | APPR BY ZHAN | |

THIRD ANGLE PROJECTION

2.54mm Pitch SL Modular
Wire To Board Connector
RHTAYL2-2.54-XX-FH

RoHS Compliance

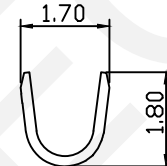
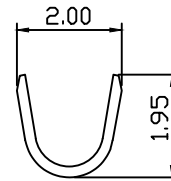
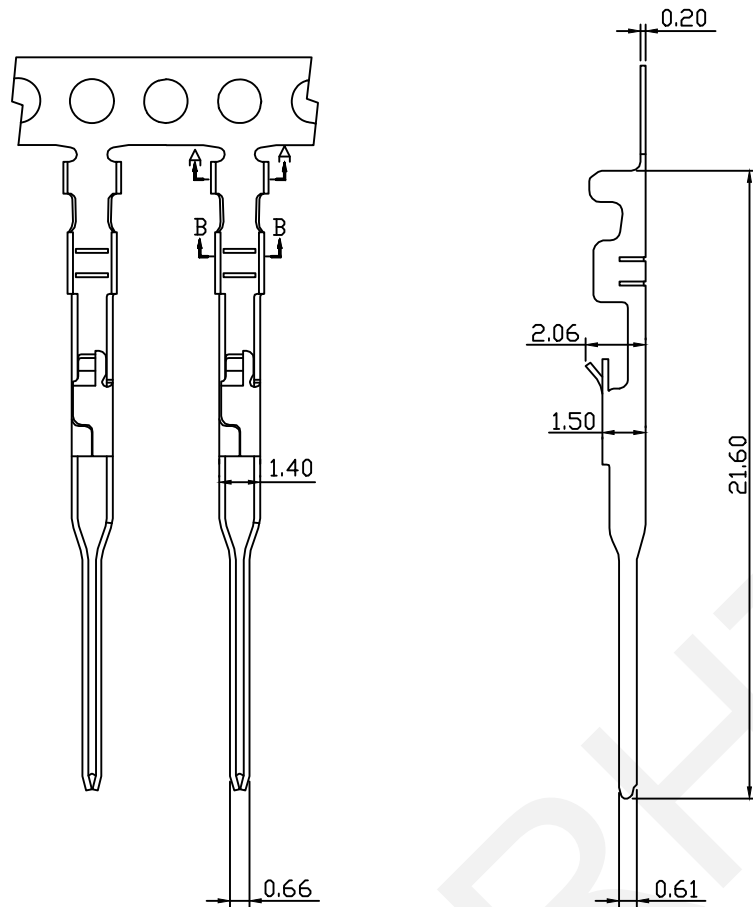

Material:
Terminal: Phosphor Bronze
Plating: Tin plated Over Gold plated
Applicable Wires: AWG #18~#22
Insulation ϕ .D: 2.10mm
Qty/Reel: 10000 PCS

Electrical Characteristics:
Rated Current: 3.0AMP
Voltage Rating: 250V AC,DC
Temperature Range: $-25^{\circ}\text{C} \sim +85^{\circ}\text{C}$
Insulator Resistance: 1000M Ω Min
Withstand Voltage: 600V AC/Minute
Contact Resistance: 20m Ω Max

Order Information

RHTAYL2-2.54-MT

Series No. _____

Pitch: 2.54mm

Type: _____

MH/FH-Hosing MT/FT-Terminal

S-Straight Male Pin

R RW-Right Angle Male Pin

VM-Vertical SMT Pin

RM-Horizontal SMT Pin

 NINGBO RHT ELECTRONIC CO.,LTD

| | | | | | |
|------------|----------------|-----------|-----------|---------------|-------------|
| UNITS:mm | SHEET SIZE: A4 | | | SCALE:--- | DRWN BY PAN |
| 0~3 | 3~18 | 18~50 | 50~120 | CHK'D BY FENG | |
| ± 0.12 | ± 0.15 | ± 0.3 | ± 0.5 | APPR BY ZHAN | |

2.54mm Pitch SL Modular Wire To Board Connector

THIRD ANGLE PROJECTION 

RHTAYL2-2.54-MT

RoHS Compliance

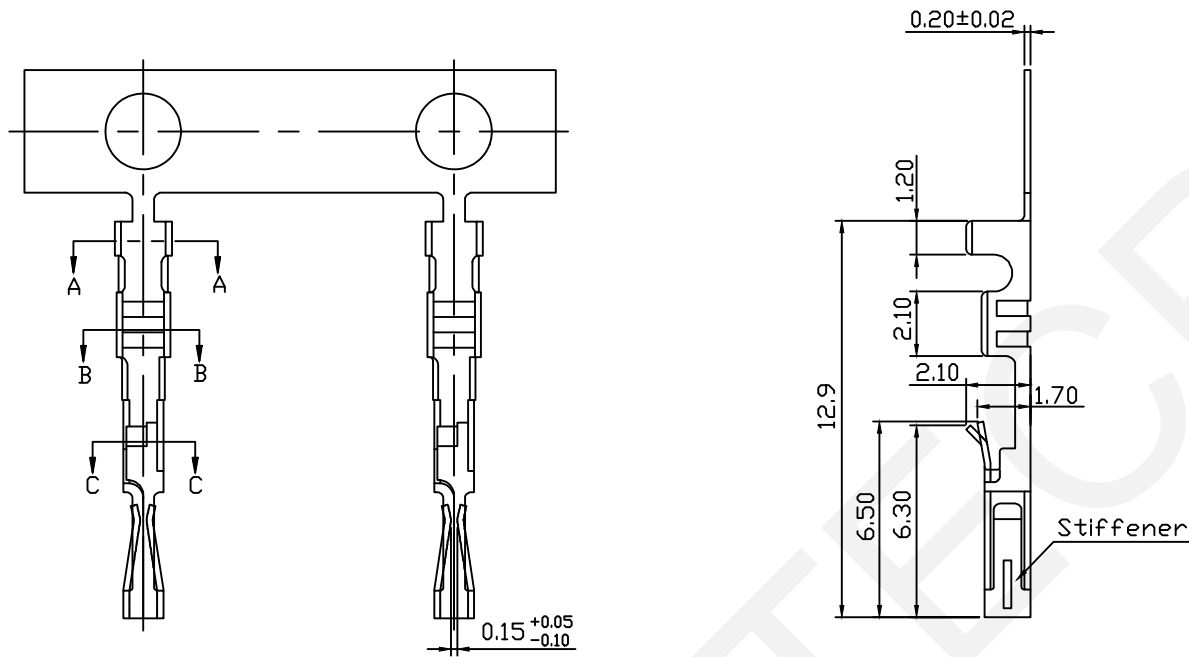

Material:
 Terminal: Phosphor Bronze
 Plating: Tin plated Over Gold plated
 Applicable Wires: AWG #28~#22
 Insulation O.D: 1.6mm
 Qty/Reel: 15000 PCS

Electrical Characteristics:
 Rated Current: 3.0AMP
 Voltage Rating: 250V AC,DC
 Temperature Range: -25°C~+85°C
 Insulator Resistance: 1000MΩ Min
 Withstand Voltage: 600V AC/Minute
 Contact Resistance: 20mΩ Max

Order Information

RHTAYL2-2.54-FT

Series No. _____

Pitch: 2.54mm

Type: _____

MH/FH-Hosing MT/FT-Terminal

S-Straight Male Pin

R RW-Right Angle Male Pin

VM-Vertical SMT Pin

RM-Horizontal SMT Pin

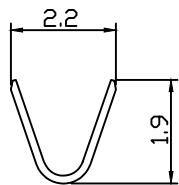

SEC A-A

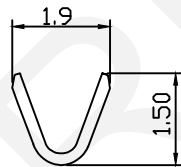

SEC B-B

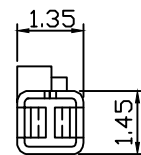

SEC C-C

NINGBO RHT ELECTRONIC CO.,LTD

| | | | | | |
|----------|----------------|-------|--------|---------------|-------------|
| UNITS:mm | SHEET SIZE: A4 | | | SCALE:--- | DRWN BY PAN |
| 0~3 | 3~18 | 18~50 | 50~120 | CHK'D BY FENG | |
| ±0.12 | ±0.15 | ±0.3 | ±0.5 | APPR BY ZHAN | |

| | |
|---|-----------------|
| 2.54mm Pitch SL Modular Wire To Board Connector | |
| THIRD ANGLE PROJECTION | RHTAYL2-2.54-FT |

RoHS Compliance

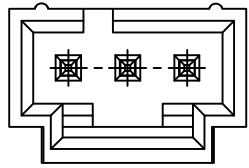

03P

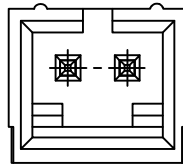

02P

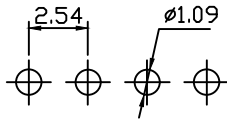
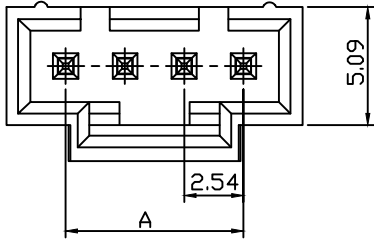

PCB LAYOUT

| Pin | Dimension(mm) | |
|-----|---------------|-------|
| | A | B |
| 02 | 2.54 | 7.63 |
| 03 | 5.08 | 10.17 |
| 04 | 7.62 | 12.71 |
| 05 | 10.16 | 15.25 |
| 06 | 12.70 | 17.79 |
| 07 | 15.24 | 20.33 |
| 08 | 17.78 | 22.87 |
| 09 | 20.32 | 25.41 |
| 10 | 22.86 | 27.95 |
| 11 | 25.40 | 30.49 |
| 12 | 27.94 | 33.03 |
| 13 | 30.48 | 35.57 |
| 14 | 33.02 | 38.11 |
| 15 | 35.56 | 40.65 |

Material:

Housing:PA66 UL94V-0,Black

Pin:Brass,Gold Plated

Electrical Characteristics:

Rated Current : 3.0AMP

Voltage Rating : 250V AC,DC

Temperature Range: -25°C~+85°C

Insulator Resistance: 1000MΩ/Min.

Withstand Voltage: 600V AC/Minute

Contact Resistance: 20MΩ/Max

Order Information

RHTAYL2-2.54-XX-S

Series No. _____

Pitch:2.54mm _____

XX-No.of 02~15Pins _____

Type: _____

MH/FH-Hosing MT/FT-Terminal

S-Straight Male Pin

R RW-Right Angle Male Pin

VM-Vertical SMT Pin

RM-Horizontal SMT Pin

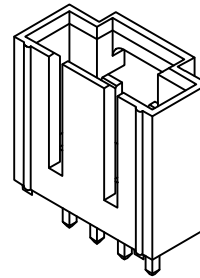
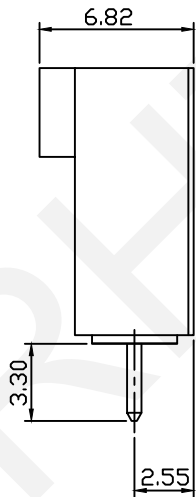
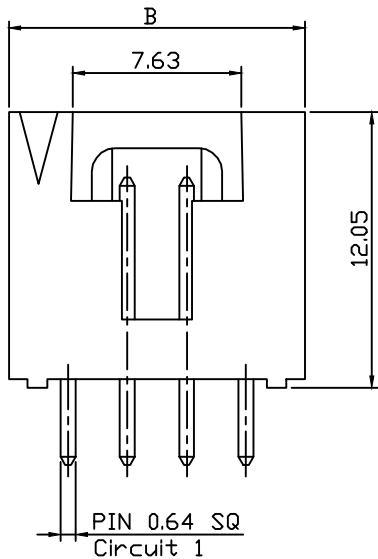

RHTECP NINGBO RHT ELECTRONIC CO.,LTD

| | | | |
|---------------|----------------|--------------|-------------|
| UNITS:mm | SHEET SIZE: A4 | SCALE:--- | DRWN BY PAN |
| 0~3 | 3~18 | 18~50 | 50~120 |
| ±0.12 | ±0.15 | ±0.3 | ±0.5 |
| CHK'D BY FENG | | APPR BY ZHAN | |

2.54mm Pitch SL Modular Wire To Board Connector

THIRD ANGLE PROJECTION

RHTAYL2-2.54-XX-S

RoHS Compliance

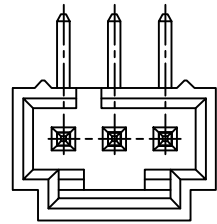

03P

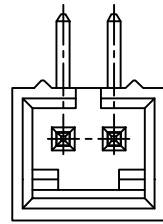

02P

| Pin | Dimension(mm) | |
|-----|---------------|-------|
| | A | B |
| 02 | 2.54 | 7.59 |
| 03 | 5.08 | 10.13 |
| 04 | 7.62 | 12.67 |
| 05 | 10.16 | 15.21 |
| 06 | 12.70 | 17.75 |
| 07 | 15.24 | 20.29 |
| 08 | 17.78 | 22.83 |
| 09 | 20.32 | 25.37 |
| 10 | 22.86 | 27.91 |
| 11 | 25.40 | 30.45 |
| 12 | 27.94 | 32.99 |
| 13 | 30.48 | 35.53 |
| 14 | 32.02 | 38.07 |
| 15 | 35.56 | 40.61 |

Material:

Housing:PA66 UL94V-0,Black

Pini:Brass,Gold Plated

Electrical Characteristics:

Rated Current : 3.0AMP

Voltage Rating : 250V AC,DC

Temperature Range: -25°C~+85°C

Insulator Resistance: 1000MΩ/Min.

Withstand Voltage: 600V AC/Minute

Contact Resistance: 20MΩ/Max

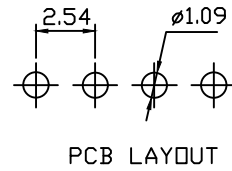
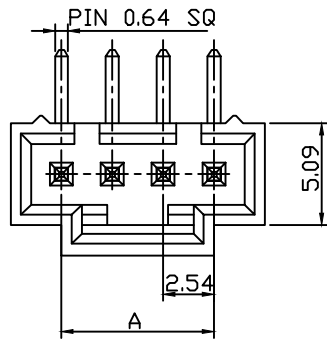

Order Information

RHTAYL2-2.54-XX-R

Series No.:

Pitch:2.54mm

XX-No.of 02~15Pins

Type:

MH/FH-Hosing MT/FT-Terminal

S-Straight Male Pin

R RW-Right Angle Male Pin

VM-Vertical SMT Pin

RM-Horizontal SMT Pin

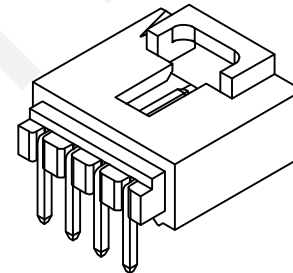
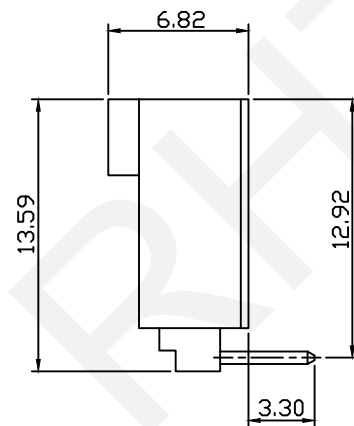
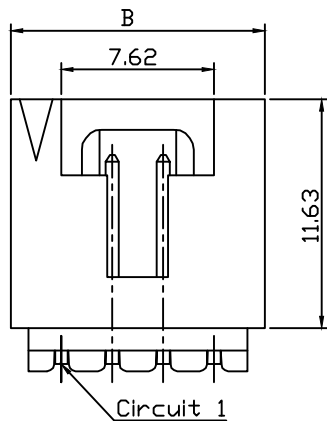

RHTECP NINGBO RHT ELECTRONIC CO.,LTD

| | | | |
|----------|----------------|-----------|-------------|
| UNITS:mm | SHEET SIZE: A4 | SCALE:--- | DRWN BY PAN |
| 0~3 | 3~18 | 18~50 | 50~120 |
| ±0.12 | ±0.15 | ±0.3 | ±0.5 |

CHK'D BY FENG
APPR BY ZHAN

2.54mm Pitch SL Modular Wire To Board Connector
THIRD ANGLE PROJECTION
RHTAYL2-2.54-XX-R

RoHS Compliance

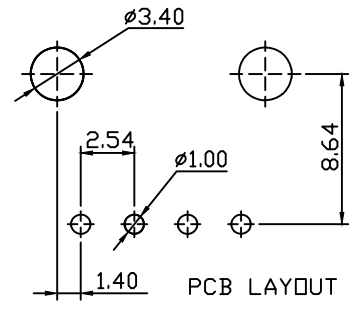
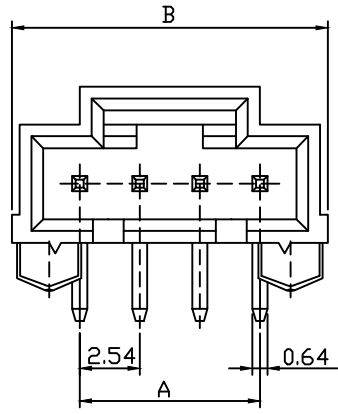

| Pin | Dimension(mm) | |
|-----|---------------|-------|
| | A | B |
| 02 | 2.54 | 8.53 |
| 03 | 5.08 | 11.07 |
| 04 | 7.62 | 13.61 |
| 05 | 10.16 | 16.51 |
| 06 | 12.70 | 18.69 |
| 07 | 15.24 | 21.23 |
| 08 | 17.78 | 23.77 |
| 09 | 20.32 | 26.31 |
| 10 | 22.86 | 28.85 |
| 11 | 25.40 | 31.39 |
| 12 | 27.94 | 33.93 |
| 13 | 30.48 | 36.47 |
| 14 | 32.02 | 39.01 |
| 15 | 35.56 | 41.55 |

Material:
Housing:PA4T UL94V-0,Black
Pin:Brass,Gold Plated

Electrical Characteristics:
Rated Current : 3.0AMP
Voltage Rating : 250V AC,DC
Temperature Range: -25°C~+85°C
Insulator Resistance: 1000MΩ/Min.
Withstand Voltage: 600V AC/Minute
Contact Resistance: 20MΩ/Max

Order Information
RHTAYL2-2.54-XX-RW

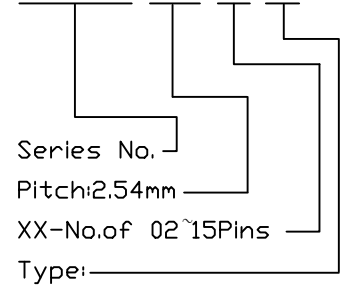

Type:
MH/FH-Hosing MT/FT-Terminal
S-Straight Male Pin
R RW-Right Angle Male Pin
VM-Vertical SMT Pin
RM-Horizontal SMT Pin

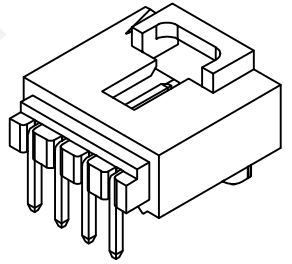
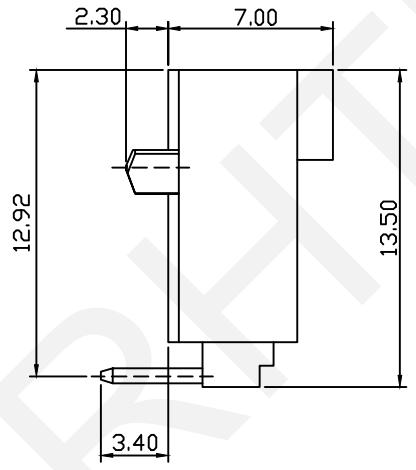
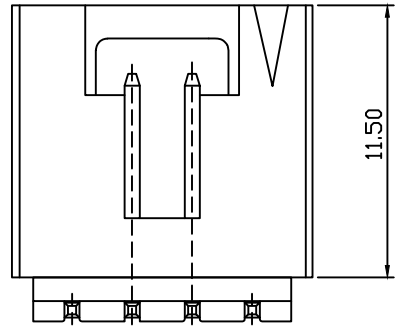

NINGBO RHT ELECTRONIC CO.,LTD

| | | | | | | |
|----------|----------------|-------|--------|---------------|---|--------------------|
| UNITS:mm | SHEET SIZE: A4 | | | | SCALE:--- | DRWN BY PAN |
| 0~3 | 3~18 | 18~50 | 50~120 | CHK'D BY FENG | 2.54mm Pitch SL Modular Wire To Board Connector | |
| ±0.12 | ±0.15 | ±0.3 | ±0.5 | APPR BY ZHAN | THIRD ANGLE PROJECTION | RHTAYL2-2.54-XX-RW |

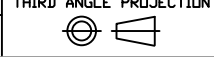

RHTAYL2-2.54-XX-RW

RoHS Compliance

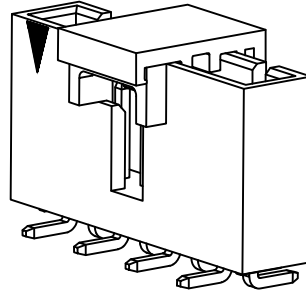
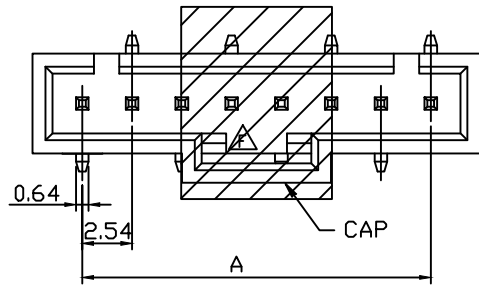

Material:

Housing: PA4T UL94V-0, Black

Pin: Brass, Gold Plated Or Tin plated

Electrical Characteristics:

Rated Current : 3.0AMP

Voltage Rating : 250V AC,DC

Temperature Range: -25°C~+85°C

Insulator Resistance: 1000MΩ/Min.

Withstand Voltage: 600V AC/Minute

Contact Resistance: 20MΩ/Max

| Pin | Dimension(mm) | |
|-----|---------------|-------|
| | A | B |
| 02 | 2.54 | 7.62 |
| 03 | 5.08 | 10.16 |
| 04 | 7.62 | 12.70 |
| 05 | 10.16 | 15.24 |
| 06 | 12.70 | 17.78 |
| 07 | 15.24 | 20.32 |
| 08 | 17.78 | 22.86 |
| 09 | 20.32 | 25.40 |
| 10 | 22.86 | 27.94 |
| 11 | 25.40 | 30.48 |
| 12 | 27.94 | 33.02 |
| 13 | 30.48 | 35.56 |
| 14 | 32.02 | 38.10 |
| 15 | 35.56 | 40.64 |

Order Information

RHTAYL2-2.54-XX-VW

Series No. _____

Pitch: 2.54mm

XX-No. of 02~15 Pins

Type: _____

MH/FH-Hosing MT/FT-Terminal

S-Straight Male Pin

R RW-Right Angle Male Pin

VM-Vertical SMT Pin

RM-Horizontal SMT Pin

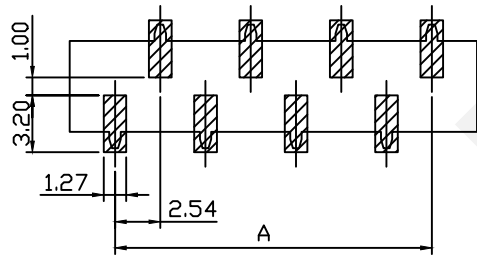
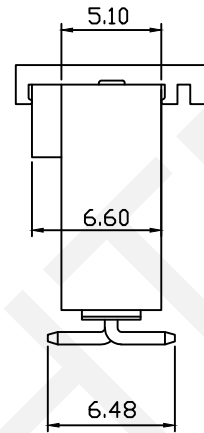
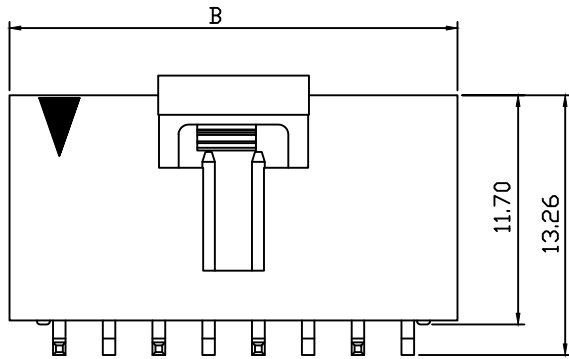

PCB LAYOUT



NINGBO RHT ELECTRONIC CO.,LTD

| | | | | | |
|----------|----------------|-------|--------|---------------|-------------|
| UNITS:mm | SHEET SIZE: A4 | | | SCALE:--- | DRWN BY PAN |
| 0~3 | 3~18 | 18~50 | 50~120 | CHK'D BY FENG | |
| ±0.12 | ±0.15 | ±0.3 | ±0.5 | APPR BY ZHAN | |

2.54mm Pitch SL Modular Wire To Board Connector

THIRD ANGLE PROJECTION

RHTAYL2-2.54-XX-VW

RoHS Compliance

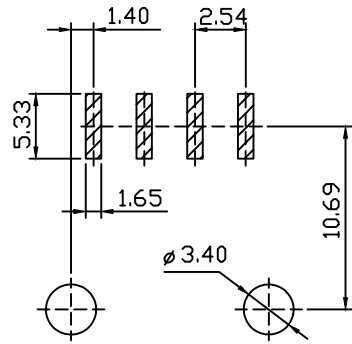
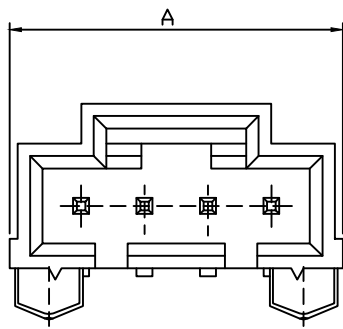

PCB LAYOUT

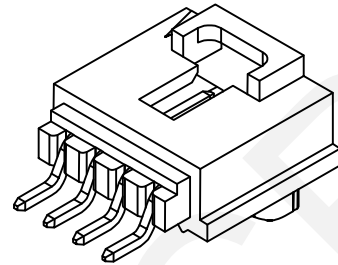

Material:

Housing:PA4T UL94V-0,Black

Pin:Brass,Gold Plated Or Tin plated

Electrical Characteristics:

Rated Current : 3.0AMP

Voltage Rating : 250V AC,DC

Temperature Range: -25°C~+85°C

Insulator Resistance: 1000MΩ/Min.

Withstand Voltage: 600V AC/Minute

Contact Resistance: 20MΩ/Max

Order Information

RHTAYL2-2.54-XX-RW

Series No. _____

Pitch:2.54mm _____

XX-No.of 02~15Pins _____

Type: _____

MH/FH-Hosing MT/FT-Terminal

S-Straight Male Pin

R RW-Right Angle Male Pin

VM-Vertical SMT Pin

RM-Horizontal SMT Pin

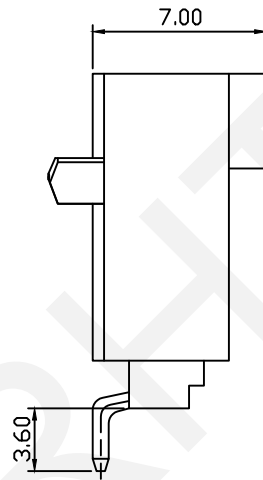
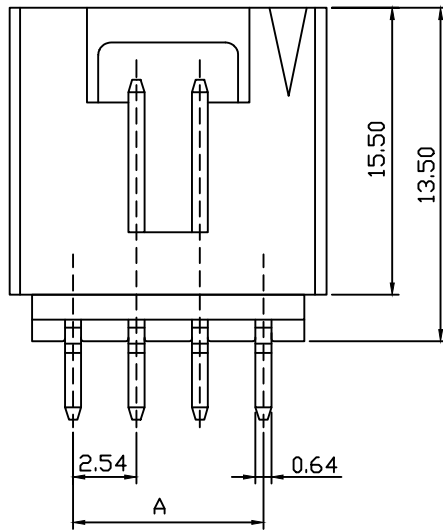

| Pin | Dimension(mm) | |
|-----|---------------|-------|
| | A | B |
| 02 | 2.54 | 8.53 |
| 03 | 5.08 | 11.07 |
| 04 | 7.62 | 13.61 |
| 05 | 10.16 | 16.51 |
| 06 | 12.70 | 18.69 |
| 07 | 15.24 | 21.23 |
| 08 | 17.78 | 23.77 |
| 09 | 20.32 | 26.31 |
| 10 | 22.86 | 28.85 |
| 11 | 25.40 | 31.39 |
| 12 | 27.94 | 33.93 |
| 13 | 30.48 | 36.47 |
| 14 | 32.02 | 39.01 |
| 15 | 35.56 | 41.55 |

NINGBO RHT ELECTRONIC CO.,LTD

| | | | |
|----------|----------------|-----------|---------------|
| UNITS:mm | SHEET SIZE: A4 | SCALE:--- | DRWN BY PAN |
| 0~3 | 3~18 | 18~50 | 50~120 |
| ±0.12 | ±0.15 | ±0.3 | ±0.5 |
| | | | CHK'D BY FENG |
| | | | APPR BY ZHAN |

2.54mm Pitch SL Modular Wire To Board Connector

THIRD ANGLE PROJECTION

RHTAYL2-2.54-XX-RW