

RoHS Compliance

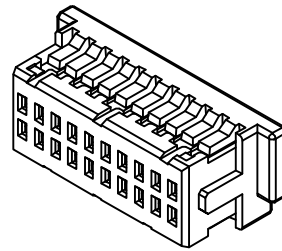

Material:
Housing: PBT(UL94V-0/V-2),White

- Electrical Characteristics:
- 1.Poles:20 To 50P
 - 2.Current Rating: 1.0A
 - 3.Voltage Rating: 50V
 - 4.Temperature Range:-25℃ To+85℃
 - 5.Contact Resistance: ≤20mΩ
 - 6.Insulation Resistance: ≥100MΩ
 - 7.Withstand Voltage: 500V AC/Minute
 - 8.Applicable Wire: AWG #32 To #28

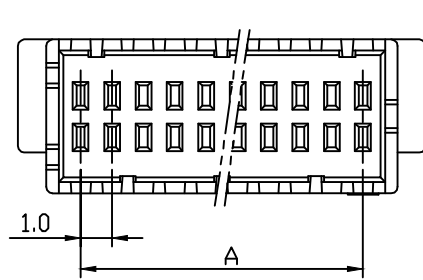
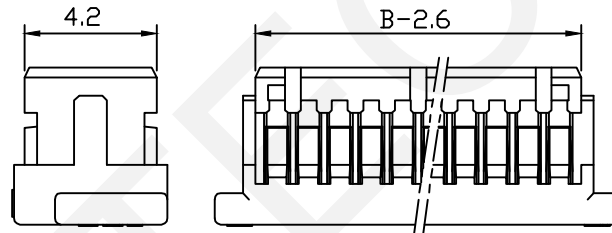
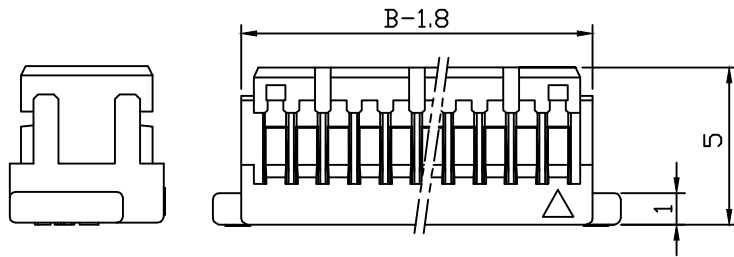

Order Information:
RHTAYF1-1.00-2-XX-H

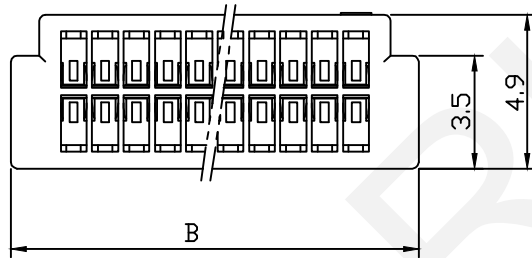
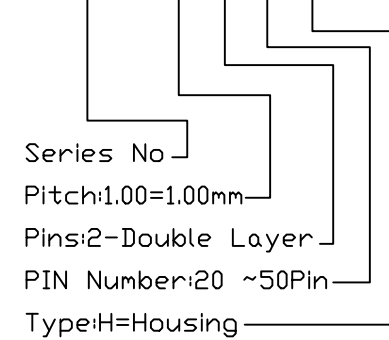

Circuit	Dimension(mm)	
	A	B
20	9.0	13.0
30	14.0	18.0
40	19.0	23.0
50	24.0	28.0

RHTECP NINGBO RHT ELECTRONIC CO.,LTD

UNITS:mm	SHEET SIZE: A4			SCALE:---	DRWN BY PAN
0~3	3~18	18~50	50~120	CHK'D BY FENG	
±0.12	±0.15	±0.3	±0.5	APPR BY ZHAN	

1.00mm Type Wire To Board Connector

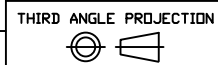

RHTAYF1-1.00-2-XX-H

RoHS Compliance

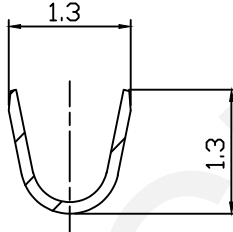
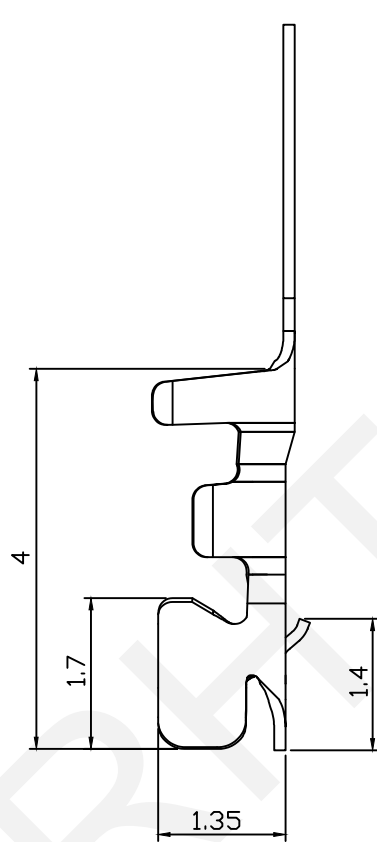
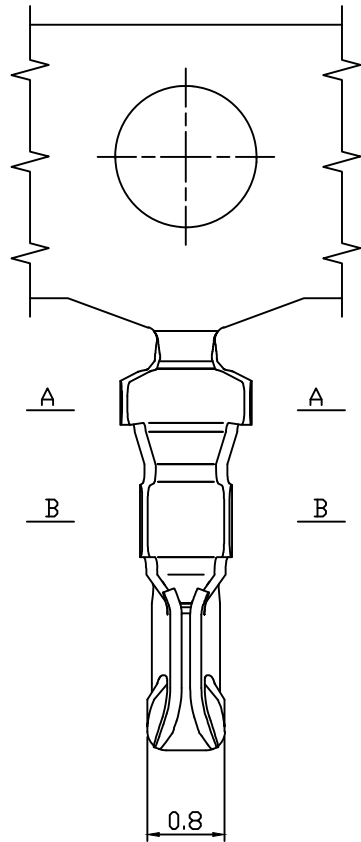

A-A

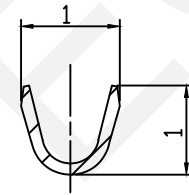

B-B

Material:
Terminal: Phos Bronze
Tin Plating: 15000PCB/Roll

Electrical Characteristics:
1. Poles: 20 To 30P
2. Current Rating: 1.0A
3. Voltage Rating: 50V
4. Temperature Range: -25°C To +85°C
5. Contact Resistance: $\leq 20m\Omega$
6. Insulation Resistance: $\geq 100M\Omega$
7. Withstand Voltage: 500V AC/Minute
8. Applicable Wire: AWG #32 To #28

Order Information:

RHTAYF1-1.00-T-X

Series No

Pitch: 1.00=1.00mm

T=Terminal

Packing: R=Reel, T=Tubes

RHTECP NINGBO RHT ELECTRONIC CO.,LTD

UNITS:mm	SHEET SIZE: A4	SCALE: ---	DRWN BY PAN
0~3	3~18	18~50	50~120
±0.12	±0.15	±0.3	±0.5
			CHK'D BY FENG
			APPR BY ZHAN

1.00mm Type Wire To Board Connector

THIRD ANGLE PROJECTION



RHTAYF1-1.00-T

RoHS Compliance

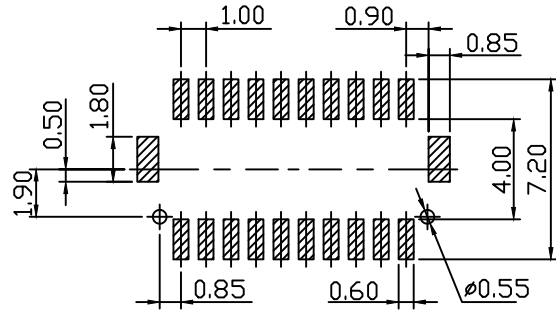

Recommend PCB Layout
All Tolerance:±0.1

Part NO.	Dimension(mm)		
	A	B	C
05P	4.00	7.30	5.70
06P	5.00	8.30	6.70
08P	7.00	10.30	8.70
10P	9.00	12.30	10.70
15P	14.00	17.30	15.70
20P	19.00	22.30	20.70
25P	24.00	27.30	25.70

Material:

Insulator:PA6R UL94V-0,Beige

Contacts:Copper Alloy

Fitting Nail:Copper Alloy

Plating:Gold Plated

Electrical Specification:

Current Rating:1A AC DC

Voltage Rating:50V AC DC

Contact Resistance:20mΩ Max

Insulation Resistance:100MΩ Min

Withstanding Voltage:500V AC/Minute

Temperature Range:-25°C~+85°C

Order Information:

RHTAYF1-1.00-2-XX-VM-X-X

Pitch:1.00mm

2-Double Layer

Pin NO:05~25

SMT Straight Male Pin

A=With Post,B=Without Post

Packing:R=Reel T=Tubes

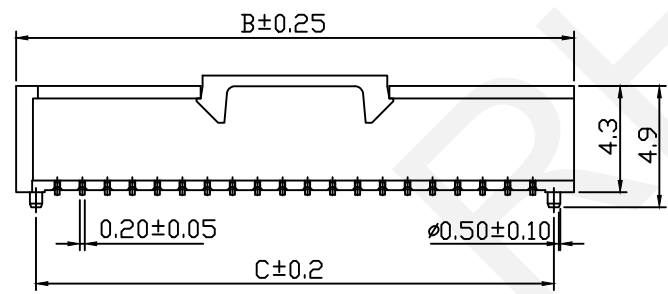
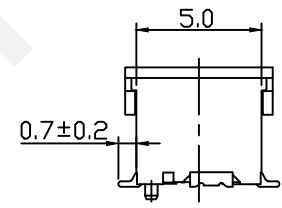
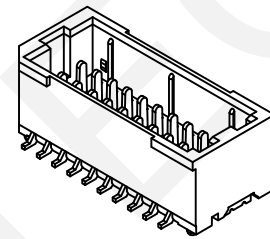
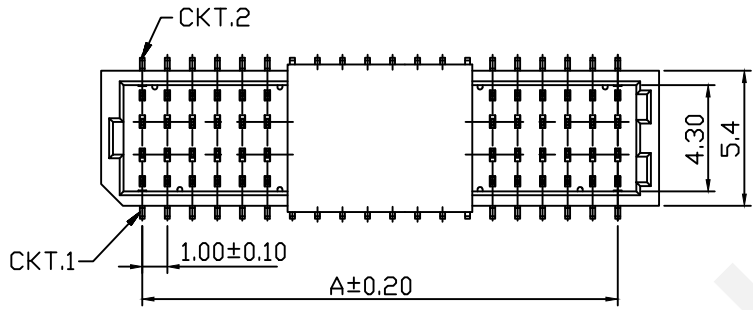

RHTECP NINGBO RHT ELECTRONIC CO.,LTD

UNITS:mm	SHEET SIZE: A4	SCALE:---	DRWN BY PAN
0~3	3~18	18~50	50~120
±0.12	±0.15	±0.3	±0.5
			CHK'D BY FENG
			APPR BY ZHAN

Pitch 1.00mm Vertical SMT Wafer,Double Layer

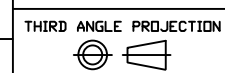

RHTAYF1-1.00-2-XX-VM

RoHS Compliance

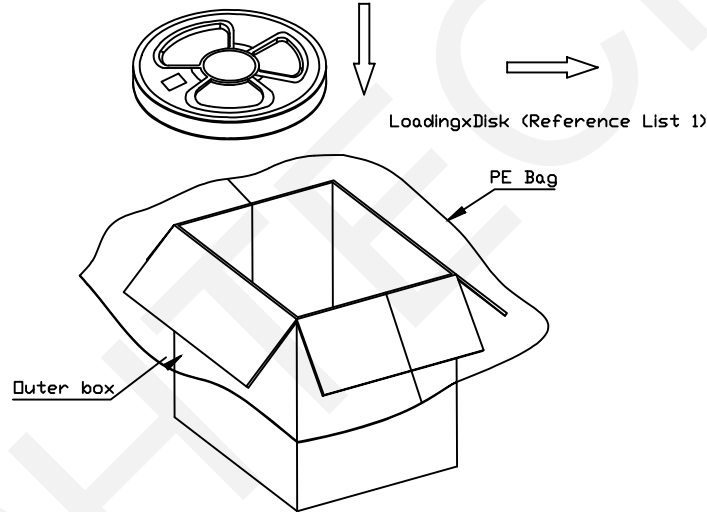
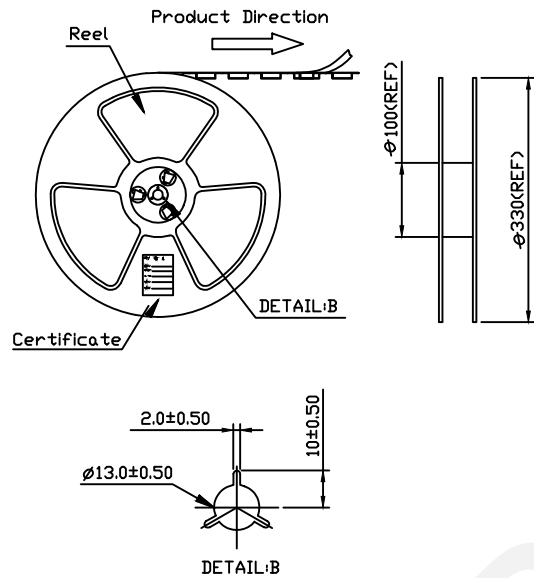
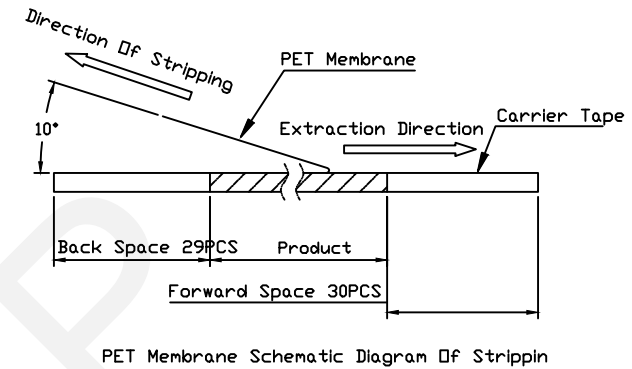
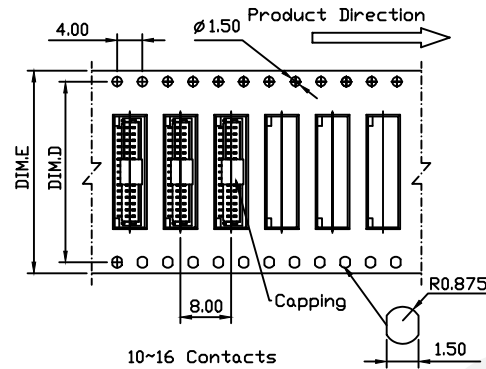
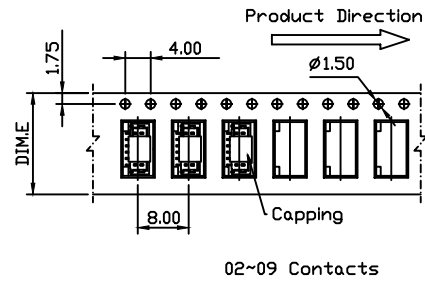

Circuit	DIM.D	DIM.E	Q'ty/Reel
02-05 PIN	--	16	1500PCS
06-14 PIN	--	24	1500PCS
15-18 PIN	28.4	32	1500PCS

Packaging Instructions

Pack The Finished Products Into Reels, Each With 1500 PCS
 The Product Will Be Packed By Pasting A Certificate On the Reel.
 The Reel Is Put Into The Outer Box, and The Outer Box is Fitted With one first Large PE Bags With Qualified Certificates Affixed On The Outer Case

RHTECP NINGBO RHT ELECTRONIC CO.,LTD

UNITS:mm	SHEET SIZE: A4	SCALE:---	DRWN BY PAN
0~3	3~18	18~50	50~120
±0.12	±0.15	±0.3	±0.5
CHK'D BY FENG		APPR BY ZHAN	

Packaging Specification
 Ptich 1.00mm Vertical SMT
 THIRD ANGLE PROJECTION

 RHTAYF1-1.00-1-XX-VM

RoHS Compliance

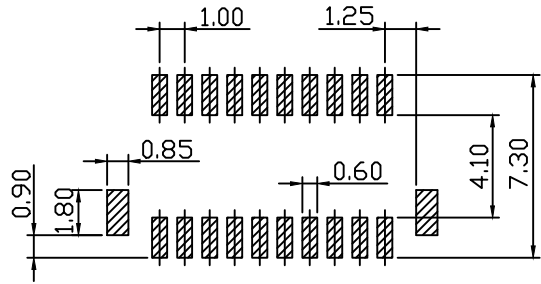

Recommend PCB Layout
All Tolerance:±0.1

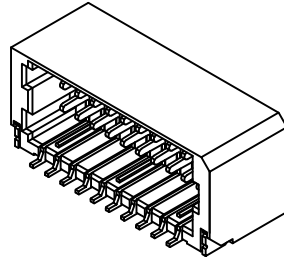

Material:
 Insulator:PA6R UL94V-0,Beige
 Contacts:Copper Alloy
 Fitting Nail:Copper Alloy
 Plating:Gold Plated

Electrical Specification:
 Current Rating:1A AC DC
 Voltage Rating:50V AC DC
 Contact Resistance:20mΩ Max
 Insulation Resistance:100MΩ Min
 Withstanding Voltage:500V AC/Minute
 Temperature Range:-25°C~+85°C

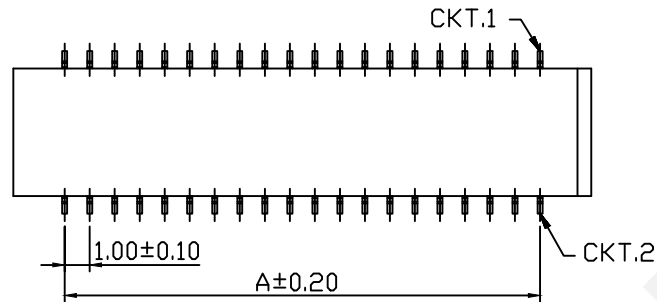

Part NO.	Dimension(mm)	
	A	B
06P	5.00	9.10
08P	7.00	11.10
10P	9.00	13.10
15P	14.00	18.10
20P	19.00	23.10
25P	24.00	28.10

Order Information:

RHTAYF1-1.00-2-XX-RM-X

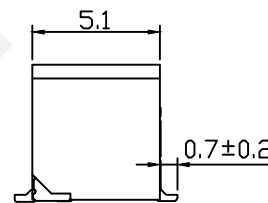
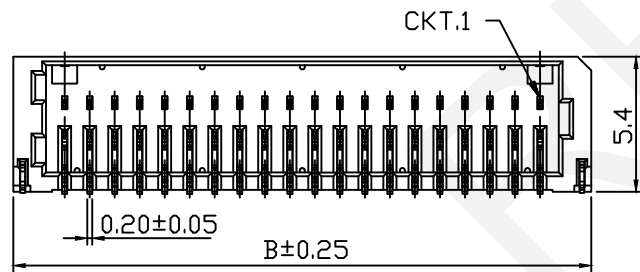

Pitch:1.00mm
 2-Double Layer
 Pin NO:06~25
 Male Pin SMT Right Angle
 Packing:R=Reel T=Tubes

RHTECP NINGBO RHT ELECTRONIC CO.,LTD

UNITS:mm SHEET SIZE: A4 SCALE:---
 0~3 3~18 18~50 50~120
 ±0.12 ±0.15 ±0.3 ±0.5

DRWN BY PAN
 CHK'D BY FENG
 APPR BY ZHAN

Pitch 1.00mm Horizontal SMT Wafer,Double Layer

THIRD ANGLE PROJECTION

RHTAYF1-1.00-2-XX-RM

RoHS Compliance

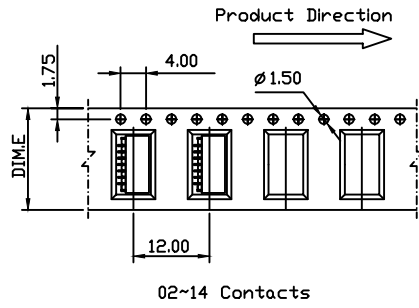

02~14 Contacts

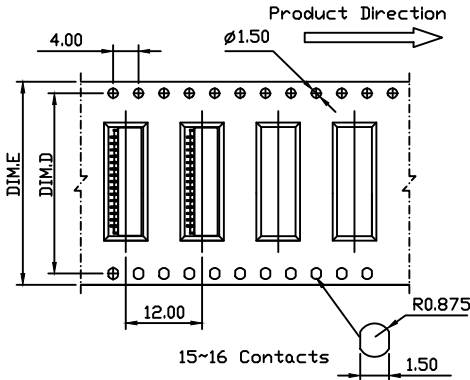

15~16 Contacts

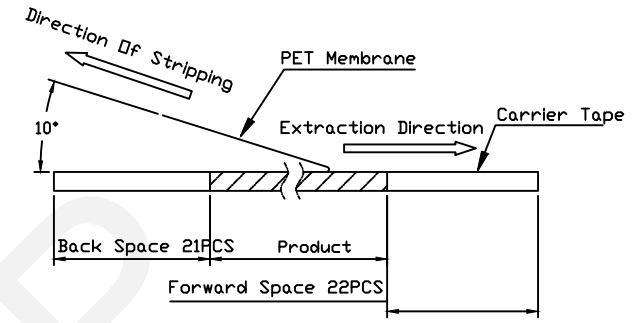

PET Membrane Schematic Diagram of Stripping

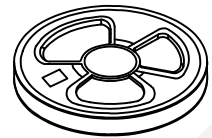
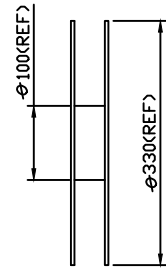
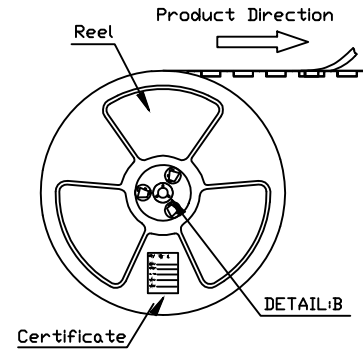

Loading Disk (Reference List 1)

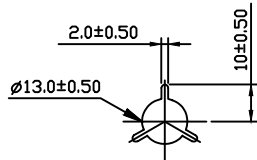
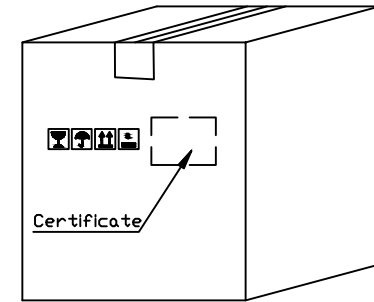
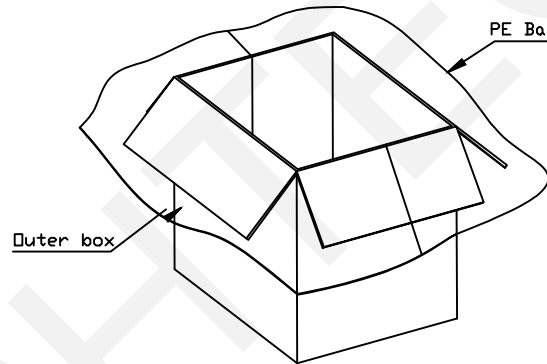

DETAIL:B

Circuit	DIM.D	DIM.E	Q'ty/Reel
02 PIN	--	12	2000PCS
03-06 PIN	--	16	1500PCS
07-14 PIN	--	24	1500PCS
15-18 PIN	28.4	32	1500PCS

Packaging Instructions

Pack The Finished Products Into Reels, Each With 1500 PCS

The Product Will Be Packed By Pasting A Certificate On the Reel.

The Reel Is Put Into The Outer Box, and The Outer Box is Fitted With one first Large PE Bags With Qualified Certificates Affixed On The Outer Case



NINGBO RHT ELECTRONIC CO.,LTD

UNITS:mm	SHEET SIZE: A4	SCALE:---	DRWN BY PAN
0~3	3~18	18~50	50~120
±0.12	±0.15	±0.3	±0.5

CHK'D BY FENG
APPR BY ZHAN

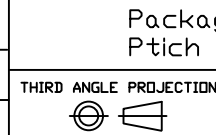

Packaging Specification
Pitch 1.00mm Horizontal SMT

RHTAYF1-1.00-1-XX-RM