

RoHS Compliance

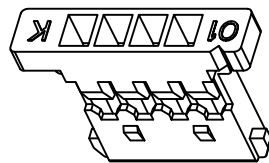
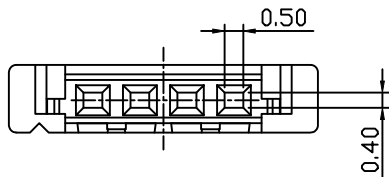

3D View

Material:  
Housing:PA66 UL94V-0

Electrical Characteristics:

Current Rating : 1.0A AC,DC  
Voltage Rating : 100V AC,DC  
Temperature Range: -25°C~+85°C  
Insulator Resistance: 100MΩ/Min.  
Withstand Voltage: 250V AC/Minute  
Contact Resistance: 20MΩ/Max

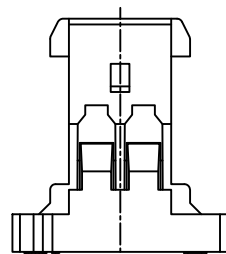
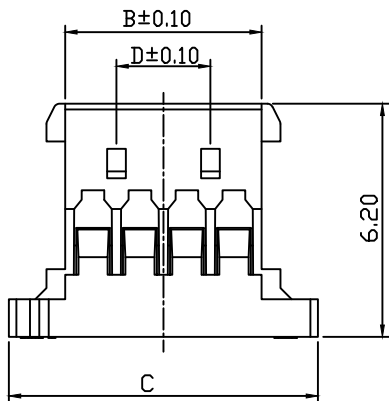

2P

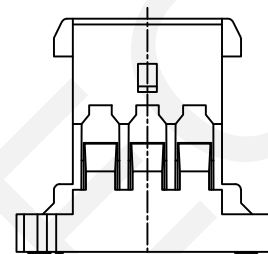

3P

Pin	Dimension(mm)			
	A	B	C	D
02	1.25	2.72	5.72	---
03	2.50	3.97	6.97	---
04	3.75	5.22	8.22	2.50
05	5.00	6.47	9.47	3.75
06	6.25	7.72	10.72	5.00
07	7.50	8.97	11.97	6.25
08	8.75	10.22	13.22	7.50
09	10.00	11.47	14.47	8.75
10	11.25	12.72	15.72	10.00
11	12.50	13.97	16.97	11.25
12	13.75	15.22	18.22	12.50
13	15.00	16.47	19.47	13.75
14	16.25	17.72	20.72	15.00
15	17.50	18.97	21.97	16.25
20	23.75	25.22	28.22	22.50
30	34.00	37.72	40.72	35.00

Order Information

RHTAYL3-1.25-XX-H

Series No.

Pitch:1.25mm

XX-No.of 02~30Pin

Type:

H-Hosing T-Terminal

RM-Horizontal SMT Pin

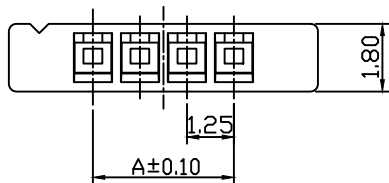

UNITS:mm	SHEET SIZE: A4	SCALE:---	DRWN BY PAN
0~3	3~18	18~50	50~120
±0.12	±0.15	±0.3	±0.5
CHK'D BY FENG		APPR BY ZHAN	

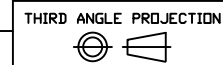

1.25mm Pitch 51146 53780  
Wire to Board Connector

RHTAYL3-1.25-XX-H

**RHTECP** NINGBO RHT ELECTRONIC CO.,LTD

RoHS Compliance

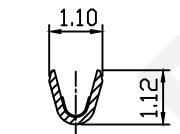
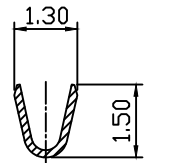
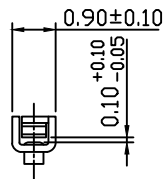
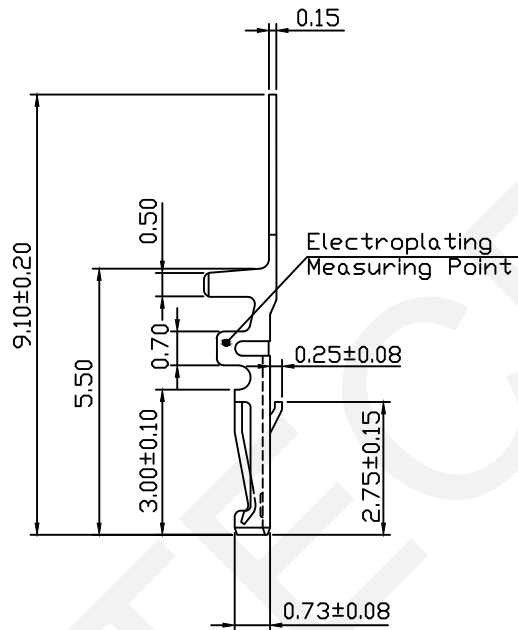
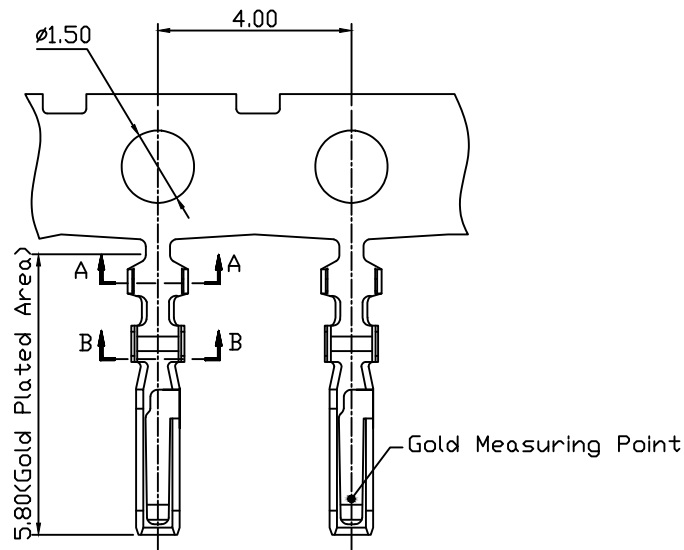

SECTION A-A

SECTION B-B

Material:  
Terminal: Phosphor Bronze  
Plating: Gold-Plated Over Tin-Plated  
Applicable Wires: AWG #28~#32  
Insulation O.D: 0.6~0.9mm

Electrical Characteristics:  
Rated Current: 1.0AMP  
Voltage Rating: 125V AC,DC  
Temperature Range: -25°C~+85°C  
Insulator Resistance: 100MΩ Min  
Withstand Voltage: 500V AC/Minute  
Contact Resistance: 20mΩ Max

Order Information

RHTAYL3-1.25-T

Series No.:

Pitch: 1.25mm

Type:

H-Hosing T-Terminal

RM-Horizontal SMT Pin

**RHTECP** NINGBO RHT ELECTRONIC CO.,LTD

UNITS:mm	SHEET SIZE: A4	SCALE:---	DRWN BY PAN
0~3	3~18	18~50	50~120
±0.12	±0.15	±0.3	±0.5

CHK'D BY FENG  
APPR BY ZHAN

1.25mm Pitch 51146 53780  
Wire to Board Connector  
THIRD ANGLE PROJECTION  
RHTAYL3-1.25-T

RoHS Compliance

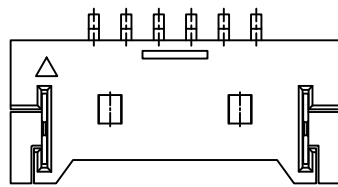

4-6P Circuits

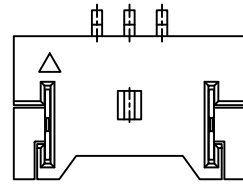

3 Circuits

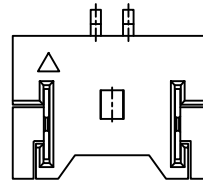

2 Circuits

Material:

Insulator: High Temperature Thermoplastics

Contact: Phosphor Bronze

Solder Nail: Brass

Plating: Gold plated over Nickel

Electrical Characteristics:

Current Rating : 1.0A AC,DC

Voltage Rating : 125V AC,DC

Temperature Range: -25°C~+85°C

Insulator Resistance: 100MΩ/Min.

Withstand Voltage: 500V AC/Minute

Contact Resistance: 20MΩ/Max

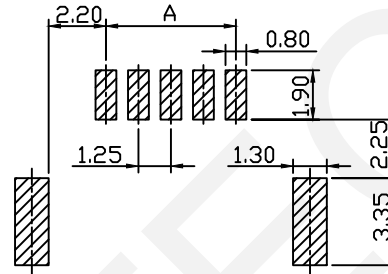
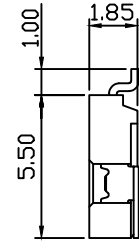
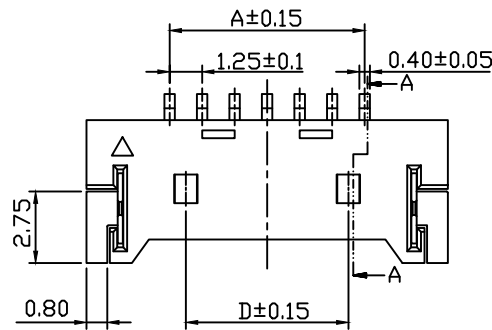

Recommended PCB Layout  
General Tolerance±0.1

Order Information

RHTAYL3-1.25-XX-RM

Series No. \_\_\_\_\_

Pitch: 1.25mm

XX-No. of 02~30Pin

Type: \_\_\_\_\_

H-Hosing T-Terminal

RM-Horizontal SMT Pin

Pin	Dimension(mm)			
	A	B	C	D
02	1.25	7.65	2.85	---
03	2.50	8.90	4.10	---
04	3.75	10.15	5.35	2.50
05	5.00	11.40	6.60	3.75
06	6.25	12.65	7.85	5.00
07	7.50	12.90	9.10	6.25
08	8.75	15.15	10.35	7.50
09	10.00	16.40	11.60	8.75
10	11.25	17.65	12.85	10.00
12	13.75	20.15	15.35	12.50
14	16.25	22.65	17.85	15.00
15	17.50	23.90	19.10	16.25
18	21.25	27.65	22.85	20.00
20	23.75	30.15	25.35	22.50
30	34.00	42.65	37.85	22.50

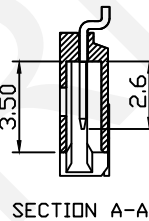
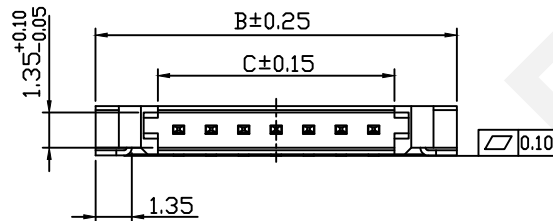

SECTION A-A

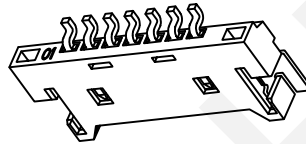

NINGBO RHT ELECTRONIC CO.,LTD

UNITS:mm

SHEET SIZE: A4

SCALE:---

DRWN BY PAN

1.25mm Pitch 51146 53780

Wire to Board Connector

0~3

3~18

18~50

50~120

CHK'D BY FENG

THIRD ANGLE PROJECTION



RHTAYL3-1.25-XX-RM

±0.12

±0.15

±0.3

±0.5

APPR BY ZHAN