

RoHS Compliance

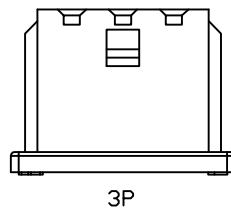
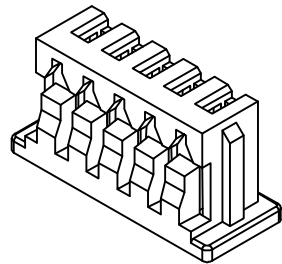
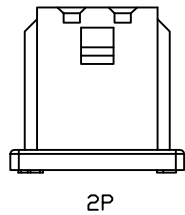
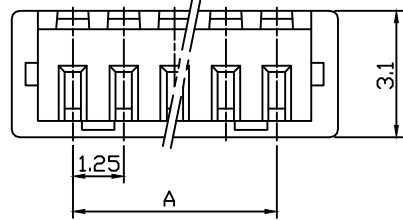
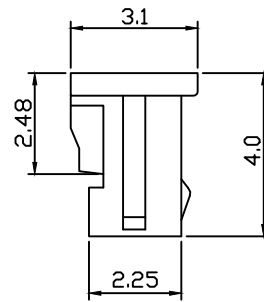
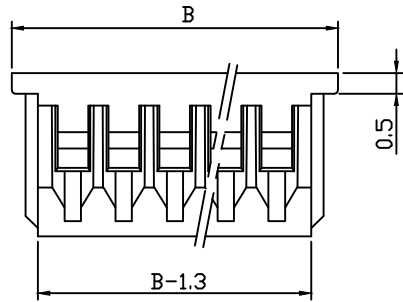

Circuit	Dimension(mm)	
	A	B
02	1.25	4.25
03	2.50	5.50
04	3.75	6.75
05	5.00	8.00
06	6.25	9.25
07	7.50	10.50
08	8.75	11.75
09	10.00	13.00
10	11.25	14.25
11	12.50	15.50
12	13.75	16.75
13	15.00	18.00
14	16.25	19.25
15	17.50	20.50
16	18.75	21.75
--	---	---
25	30.00	33.00

Material:

Housing:PA66(UL94V-0/V-2),White

Electrical Characteristics:

- 1.Poles: 2 to 25P
- 2.Current Rating: 1.0A
- 3.Voltage Rating:125V
- 4.Temperature Range:-25℃ To +85℃
- 5.Contact Resistance: ≤20mΩ
- 6.Insulation Resistance: ≥100MΩ
- 7.Withstand Voltage:500V AC/Minute
- 8.Applicable Wire: AWG #32 To #28
- 9.Applicable PC Board Thickness: 0.8mm

Order Information

RHTAYL1-1.25-XX-H

Series No.:

Pitch:1.25=1.25mm

PIN Number: 02~25Pin

Type:H=Housing

 NINGBO RHT ELECTRONIC CO.,LTD

UNITS:mm	SHEET SIZE: A4			SCALE:---	DRWN BY PAN
0~3	3~18	18~50	50~120	CHK'D BY FENG	
±0.12	±0.15	±0.3	±0.5	APPR BY ZHAN	

1.25mm Type Wire To Board Connector

THIRD ANGLE PROJECTION

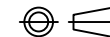

RHTAYL1-1.25-XX-H

RoHS Compliance

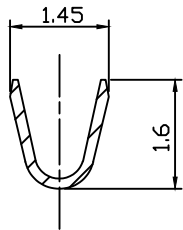
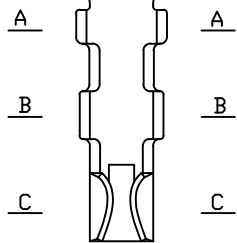
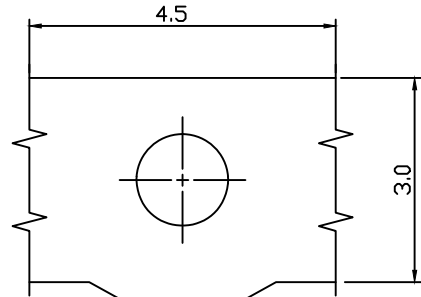

A-A

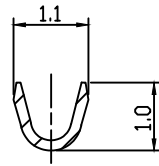

B-B

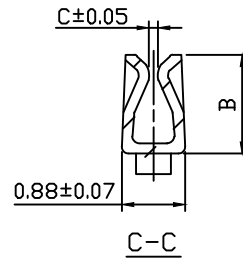
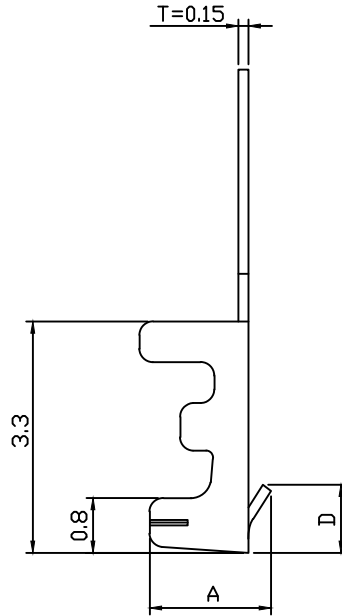

C-C

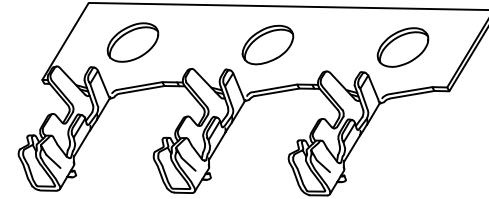

Electrical Characteristics:

- Current Rating: 1.0A
- Voltage Rating: 125V
- Temperature Range: -25°C To +85°C
- Contact Resistance: ≤20mΩ
- Insulation Resistance: ≥100MΩ
- Withstand Voltage: 500V AC/Minute
- Applicable Wire: AWG #32 To #28
- Applicable PC Board Thickness: 0.8mm

Order Information

RHTAYL1-1.25-T

Series No.

Pitch: 1.25=1.25mm

Terminal: See Table

A	B	C	D	Material	Finish	Aty/Reet
1.78	1.45	0.13	1.0	Phosphor Bronze	TIN	12000 PCS

UNITS:mm	SHEET SIZE: A4	SCALE:---	DRWN BY PAN
0~3	3~18	18~50	50~120
±0.12	±0.15	±0.3	±0.5
CHK'D BY FENG		APPR BY ZHAN	

1.25mm Type Wire To Board Connector

THIRD ANGLE PROJECTION

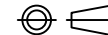

RHTAYL1-1.25-T

RHTECP NINGBO RHT ELECTRONIC CO.,LTD



RoHS Compliance

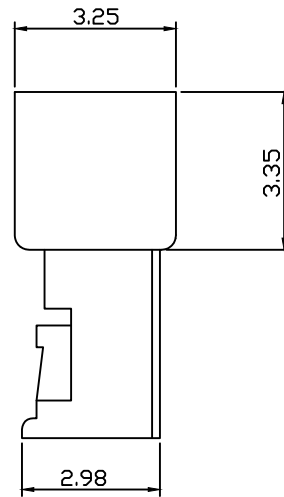
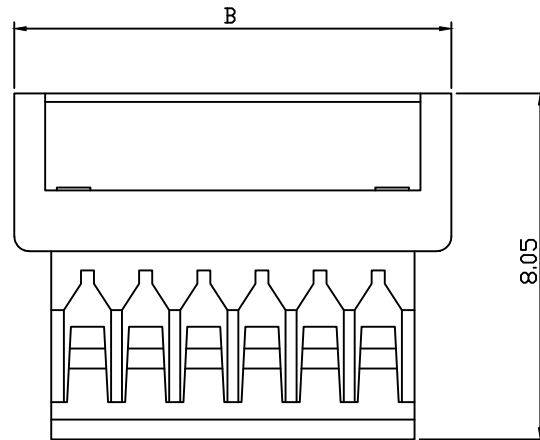
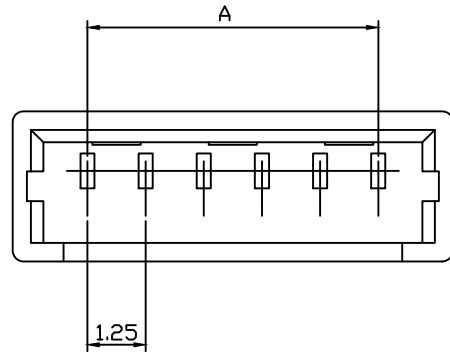

Circuit	Dimension(mm)	
	A	B
02	1.25	4.25
03	2.50	5.50
04	3.75	6.75
05	5.00	8.00
06	6.25	9.25
07	7.50	10.50
08	8.75	11.75
09	10.00	13.00
10	11.25	14.25
11	12.50	15.50
12	13.75	16.75
13	15.00	18.00
14	16.25	19.25
15	17.50	20.50

Material:
Housing:PA66,UL94V-0,White

- Electrical Characteristics:
- 1.Poles: 2 to 15P
 - 2.Current Rating: 1.0A
 - 3.Voltage Rating:125V
 - 4.Temperature Range:-25℃ To +85℃
 - 5.Contact Resistance: $\leq 20m\Omega$
 - 6.Insulation Resistance: $\geq 100M\Omega$
 - 7.Withstand Voltage:500V AC/Minute

Order Information
RHTAYL1-1.25-XX-H2

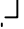
Series No. 
Pitch:1.25=1.25mm
PIN Number: 02~15Pin
Type:H2=Housing

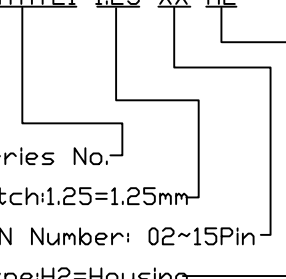

 NINGBO RHT ELECTRONIC CO.,LTD

UNITS:mm	SHEET SIZE: A4	SCALE:---	DRWN BY PAN
0~3	3~18	18~50	50~120
±0.12	±0.15	±0.3	±0.5
CHK'D BY FENG		APPR BY ZHAN	

1.25mm Type Wire To Board Connector

THIRD ANGLE PROJECTION

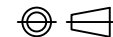

RHTAYL1-1.25-XX-H2

RoHS Compliance

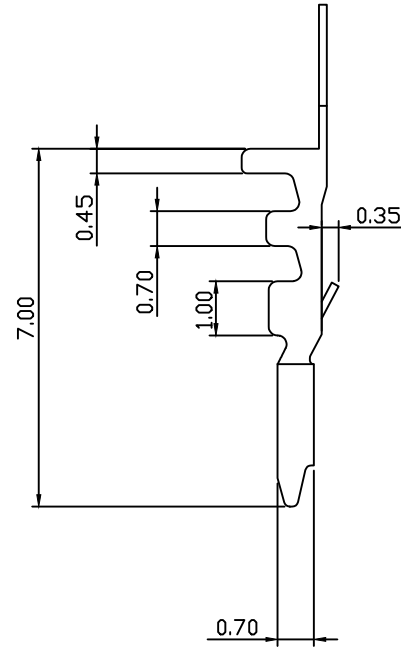
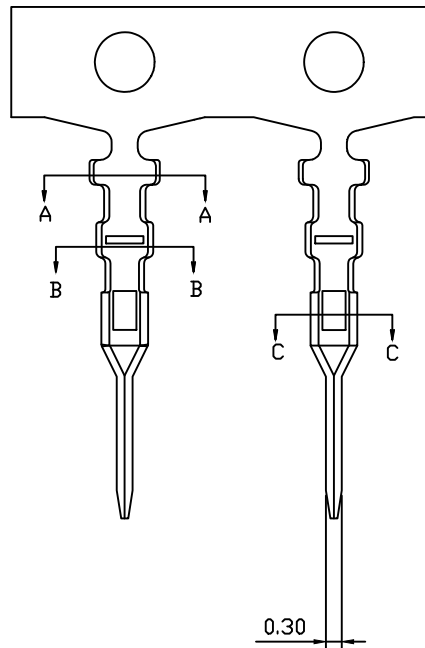

Electrical Characteristics:
 Current Rating: 1.0A
 Voltage Rating: 125V
 Temperature Range: -25°C To +85°C
 Contact Resistance: ≤20mΩ
 Insulation Resistance: ≥100MΩ
 Withstand Voltage: 500V AC/Minute

Order Information

RHTAYL1-1.25-T2

Series No.

Pitch: 1.25=1.25mm

Terminal: See Table

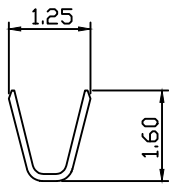

A-A

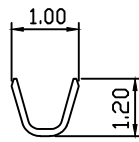

B-B

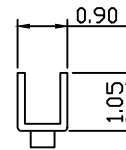

C-C

RHTECP NINGBO RHT ELECTRONIC CO.,LTD

UNITS:mm	SHEET SIZE: A4			SCALE:---	DRWN BY PAN
0~3	3~18	18~50	50~120	CHK'D BY FENG	
±0.12	±0.15	±0.3	±0.5	APPR BY ZHAN	

1.25mm Type Wire To Board Connector

THIRD ANGLE PROJECTION

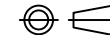

RHTAYL1-1.25-T2

RoHS Compliance

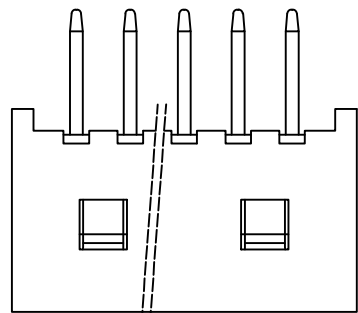

4P-25P

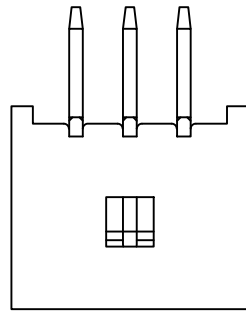

3P

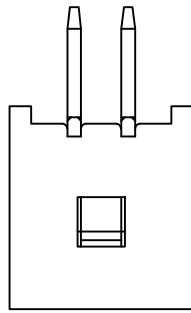

2P

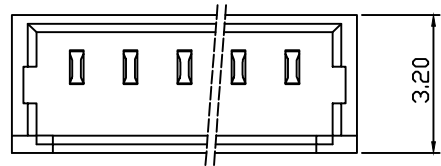

3.20

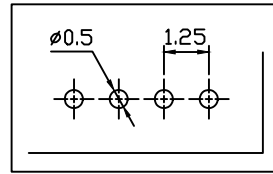
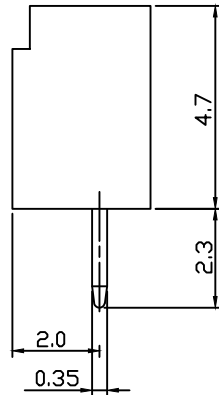
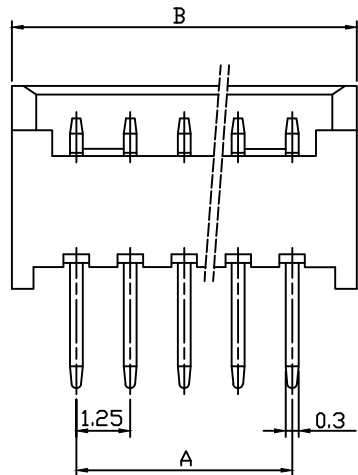
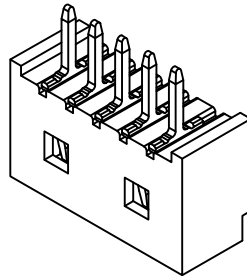

PCB Layout

Circuit	Dimension(mm)	
	A	B
02	1.25	4.25
03	2.50	5.50
04	3.75	6.75
05	5.00	8.00
06	6.25	9.25
07	7.50	10.50
08	8.75	11.75
09	10.00	13.00
10	11.25	14.25
11	12.50	15.50
12	13.75	16.75
13	15.00	18.00
14	16.25	19.25
15	17.50	20.50
16	18.75	21.75
--	---	---
25	30.00	33.00

Material:

Housing:PA66(UL94V-0/V-2),White

Contact:Phosphor Bronze, Tin Plated

Electrical Characteristics:

1.Poles: 2 to 25P

2.Current Rating: 1.0A

3.Voltage Rating: 125V

4.Temperature Range:-25℃ To +85℃

5.Contact Resistance: ≤20mΩ

6.Insulation Resistance: ≥100MΩ

7.Withstand Voltage: 500V AC/Minute

8.Applicable Wire: AWG #32 To #28

9.Applicable PC Board Thickness: 0.8mm

Order Information

RHTAYL1-1.25-XX-S

Series No.

Pitch:1.25=1.25mm

PIN Number: 02~25Pin

Type:S-Straight Male Pin

RHTECP NINGBO RHT ELECTRONIC CO.,LTD

UNITS:mm

SHEET SIZE: A4

SCALE:---

DRWN BY PAN

1.25mm Type Wire To Board Connector

0~3

3~18

18~50

50~120

CHK'D BY FENG

THIRD ANGLE PROJECTION

±0.12

±0.15

±0.3

±0.5

APPR BY ZHAN



RHTAYL1-1.25-XX-S



RoHS Compliance

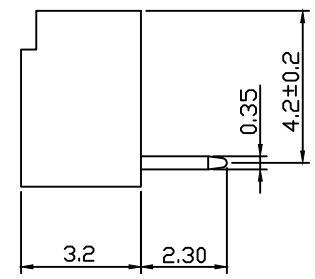
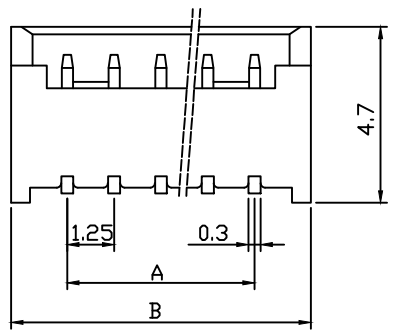

Circuit	Dimension(mm)	
	A	B
02	1.25	4.25
03	2.50	5.50
04	3.75	6.75
05	5.00	8.00
06	6.25	9.25
07	7.50	10.50
08	8.75	11.75
09	10.00	13.00
10	11.25	14.25
11	12.50	15.50
12	13.75	16.75
13	15.00	18.00
14	16.25	19.25
15	17.50	20.50
16	18.75	21.75
--	---	---
25	30.00	33.00

Material:
 Housing:PA66(UL94V-0/V-2),White
 Contact:Phosphor Bronze, Tin Plated

- Electrical Characteristics:
- 1.Poles: 2 to 25P
 - 2.Current Rating: 1.0A
 - 3.Voltage Rating: 125V
 - 4.Temperature Range:-25℃ To +85℃
 - 5.Contact Resistance: ≤20mΩ
 - 6.Insulation Resistance: ≥100MΩ
 - 7.Withstand Voltage: 500V AC/Minute
 - 8.Applicable Wire: AWG #32 To #28
 - 9.Applicable PC Board Thickness: 0.8mm

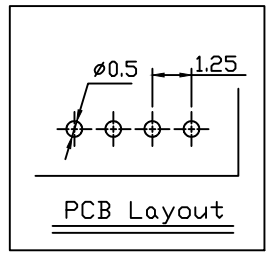
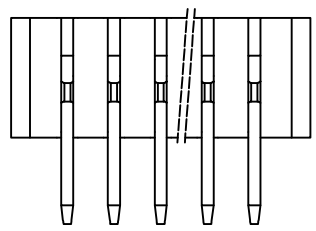

Order Information

RHTAYL1-1.25-XX-R

Series No.
 Pitch:1.25=1.25mm
 PIN Number: 02~25Pin
 Type:Right Angle Male Pin

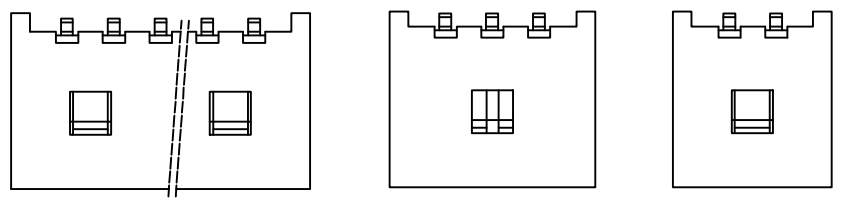

4P-25P

3P

2P

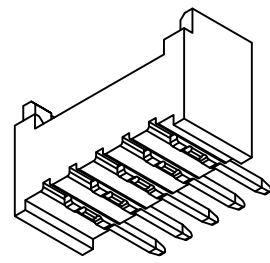

NINGBO RHT ELECTRONIC CO.,LTD

UNITS:mm	SHEET SIZE: A4				SCALE:---	DRWN BY PAN
0~3	3~18	18~50	50~120	CHK'D BY FENG	1.25mmType Wire To Board Connector	
±0.12	±0.15	±0.3	±0.5	APPR BY ZHAN	THIRD ANGLE PROJECTION	RHTAYL1-1.25-XX-R

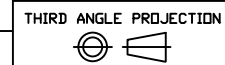

RoHS Compliance

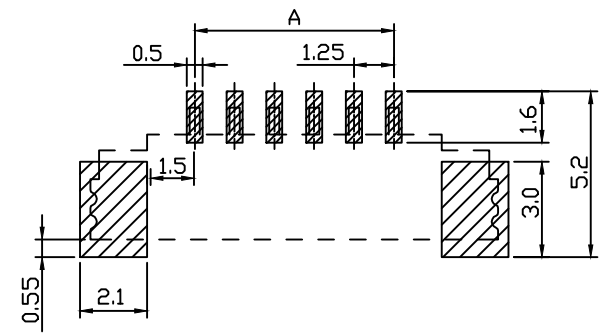
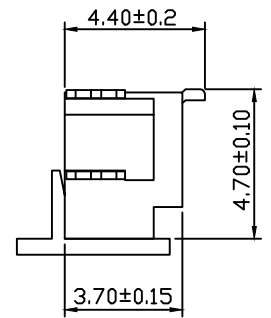
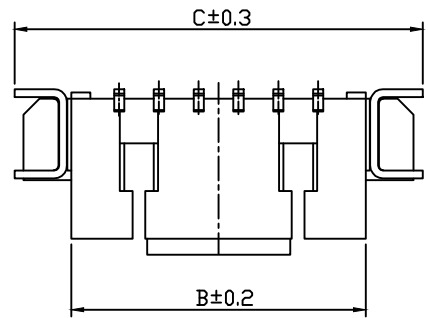

Suggested PCB Layout

Material:
 Housing:LCP UL94V-0,Beige
 Contact:Phosphor Bronze,Tin Plated
 Solder Tab:Brass Tin Plated
 Electrical Specification:
 Poles:02 to 16P
 Contact Resistance: ≤20mΩ
 Insulation Resistance: ≥100MΩ
 Rated Voltage:125V AC DC
 Rated Current:1.0A AC DC
 Withstand Voltage:500V AC/Minute
 Temperature Range:-25℃~+105℃

Circuit	Dimension(mm)			
	A	B	C	D
02	1.50	4.25	7.75	3.05
03	2.50	5.50	9.00	4.30
04	3.75	6.75	10.25	5.55
05	5.00	8.00	11.50	6.80
06	6.25	9.25	12.75	8.05
07	7.50	10.50	14.00	9.30
08	8.75	11.75	15.25	10.55
09	10.00	13.00	16.50	11.80
10	11.25	14.25	17.75	13.05
11	12.50	15.50	19.00	14.30
12	13.75	16.75	20.25	15.55
13	15.00	18.00	21.50	16.80
14	16.25	19.25	22.75	18.05
15	17.50	20.50	24.00	19.30
16	18.75	21.75	25.25	20.55

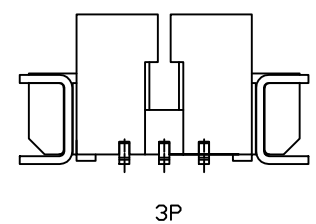
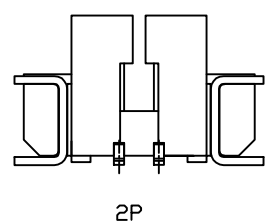
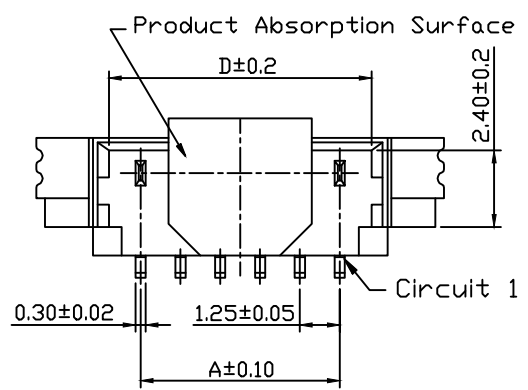

RHTECP NINGBO RHT ELECTRONIC CO.,LTD

UNITS:mm SHEET SIZE: A4 SCALE:---
 0~3 3~18 18~50 50~120
 ±0.12 ±0.15 ±0.3 ±0.5

DRWN BY PAN
 CHK'D BY FENG
 APPR BY ZHAN

Ptich 1.25mm Vertical SMT Wafer
 THIRD ANGLE PROJECTION
 RHTAYL1-1.25-XX-VM-R

RoHS Compliance

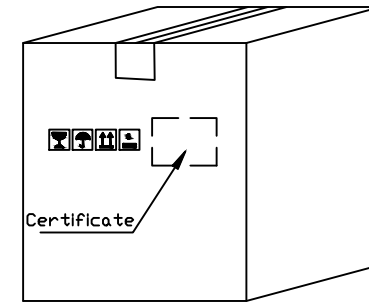
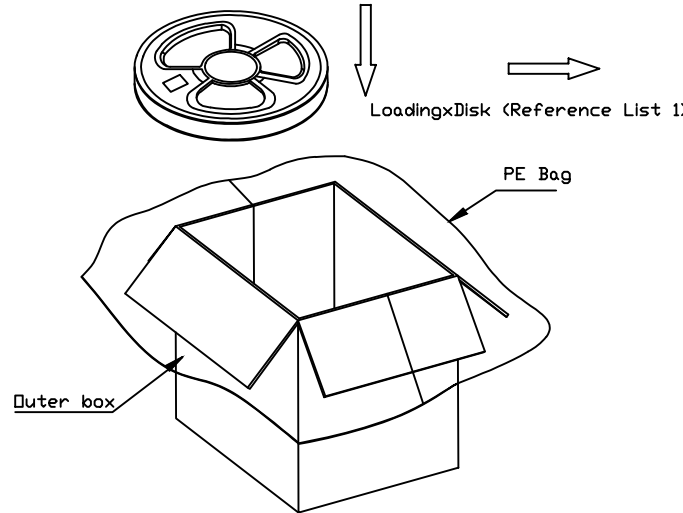
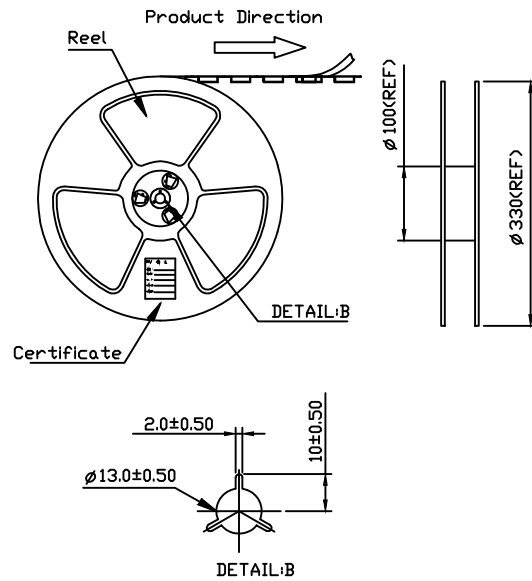
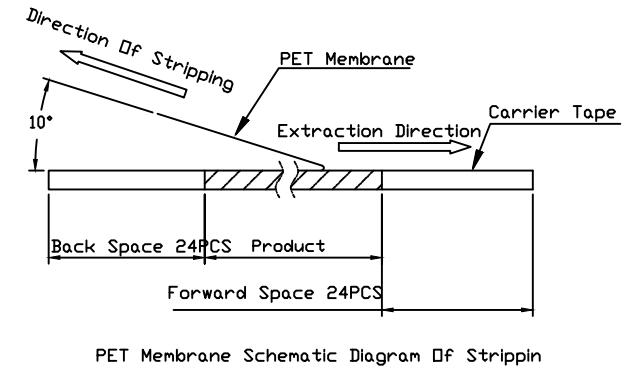
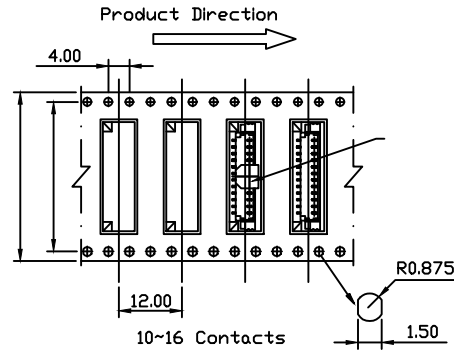
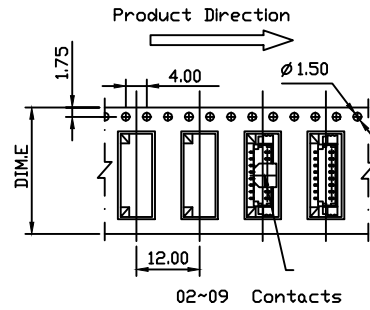

Packaging Instructions

Pack The Finished Products Into Reels, Each With 1000 PCS
 The Product Will Be Packed by pasting A certificate On the Reel.
 The Reel Is Put Into The Outer Box, and The Outer Box is Fitted
 With one first Large PE Bags With Qualified Certificates Affixed
 On The Outer Case

Circuit	DIM.D	DIM.E	Q'ty/Reel
02-03 PIN	--	16	1000PCS
04-09 PIN	--	24	1000PCS
10-13 PIN	28.4	32	1000PCS
14-16 PIN	40.4	44	1000PCS

UNITS:mm	SHEET SIZE: A4	SCALE:---	DRWN BY PAN
0~3	3~18	18~50	50~120
±0.12	±0.15	±0.3	±0.5
CHK'D BY FENG		APPR BY ZHAN	

Packaging Specification Pitch 1.25mm Vertical SMT	
THIRD ANGLE PROJECTION 	RHTAYL1-1.25-XX-VM-R

NINGBO RHT ELECTRONIC CO.,LTD

RoHS Compliance

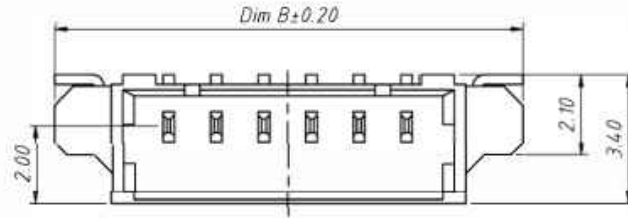
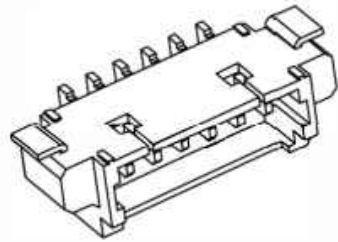

Electrical Specification:
 Voltage rating: 125V AC/DC
 Current rating: 1.0A AC/DC
 Withstand Voltage: 250V AC/minute
 Insulation resistance: 100MΩ min
 Contact resistance: 20mΩ max
 Temperature Range: -25°C ~ + 85°C

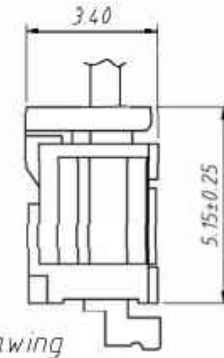
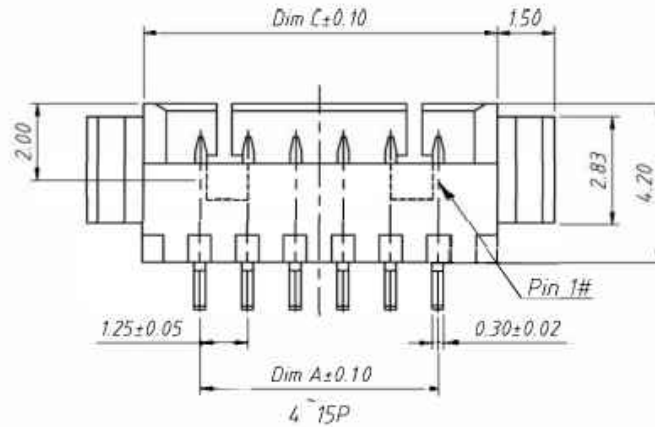
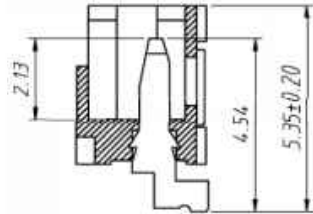

Mating Height Drawing

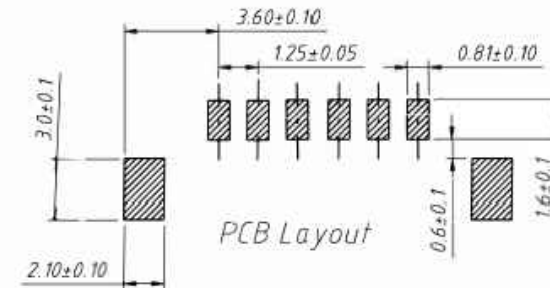
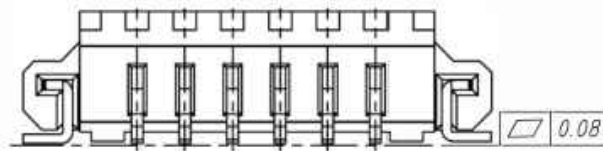
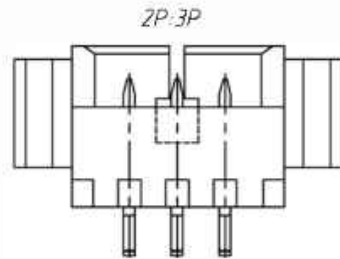

PCB Layout

Circuit	Dimensions (mm)			Circuit	Dimensions (mm)		
	A	B	C		A	B	C
02	1.25	7.25	4.75	10	11.25	17.25	14.25
03	2.50	8.50	5.50	11	12.50	18.50	15.50
04	3.75	9.75	6.75	12	13.75	19.75	16.75
05	5.00	11.00	8.00	13	15.00	21.00	18.00
06	6.25	12.25	9.25	14	16.25	22.25	19.25
07	7.50	13.50	10.50	15	17.50	23.50	20.50
08	8.75	14.75	11.75				
09	10.00	16.00	13.00				

Material:
 Poles: 02 to 15P
 Insulator: Nylon 4,6, UL 94 V-0
 Colour: Beige
 Contacts: Phosphor Bronze
 Plating: Tin Plated
 Solder Tab: Brass
 Plating: Tin Plated

RHTECP NINGBO RHT ELECTRONIC CO.,LTD

UNITS:mm SHEET SIZE: A4 SCALE: ---
 DRWN BY PAN
 0~3 3~18 18~50 50~120
 CHK'D BY FENG
 ±0.12 ±0.15 ±0.3 ±0.5
 APPR BY ZHAN

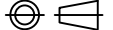
1.25mm SMT 90° Wafer Connector
 THIRD ANGLE PROJECTION

 RHTAYL1-1.25-XX-RM-R

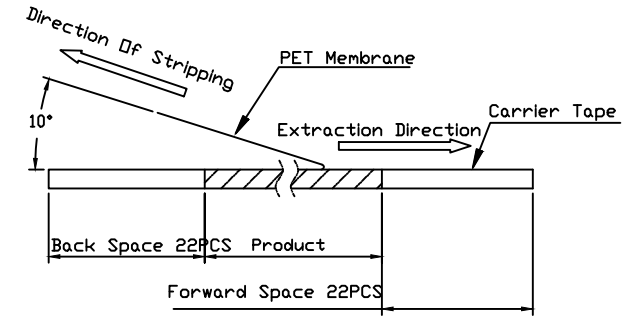
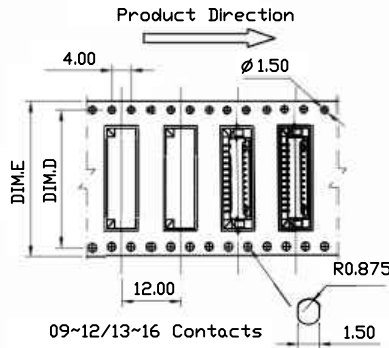
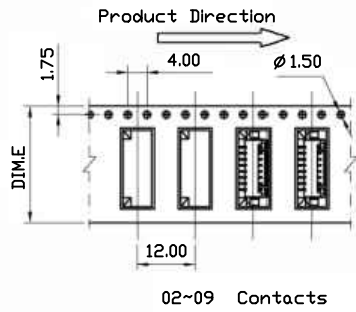
RoHS Compliance

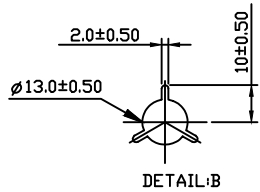
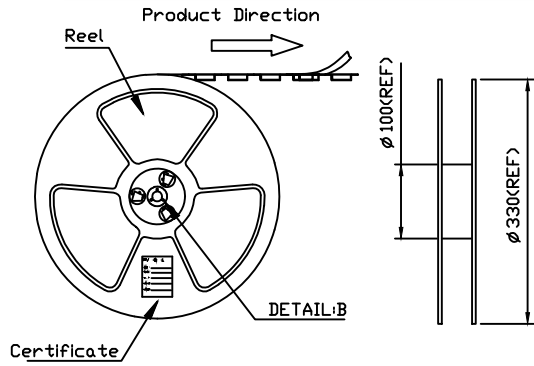

PET Membrane Schematic Diagram of Stripping



Circuit	DIM.D	DIM.E	Q'ty/Reel
02 PIN	--	12	2000PCS
03-06 PIN	--	16	1500PCS
07-14 PIN	--	24	1500PCS
15-18 PIN	28.4	32	1500PCS

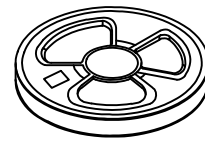

Loading Disk (Reference List 1)

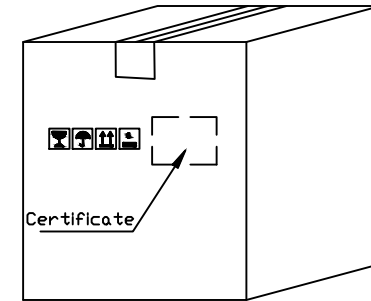
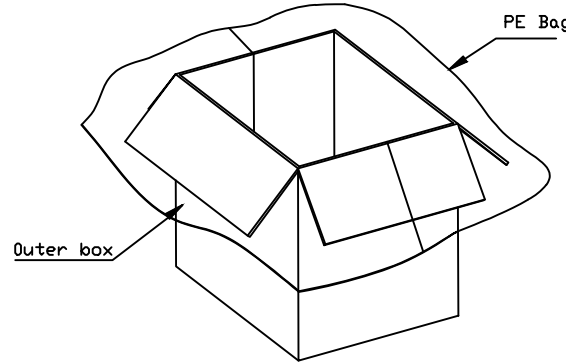

Packaging Instructions

Pack The Finished Products Into Reels, Each With 1500 PCS

The Product Will Be Packed by pasting A certificate On the Reel.

The Reel Is Put Into The Outer Box, and The Outer Box is Fitted

With one first Large PE Bags With Qualified Certificates Affixed

On The Outer Case



NINGBO RHT ELECTRONIC CO.,LTD

UNITS:mm	SHEET SIZE: A4	SCALE:---	DRWN BY PAN
0~3	3~18	18~50	50~120
±0.12	±0.15	±0.3	±0.5
CHK'D BY FENG		APPR BY ZHAN	

Packaging Specification	
Pitch 1.25mm Horizontal SMT	
THIRD ANGLE PROJECTION	RHTAYL1-1.25-XX-RM-R