

Outline Drawing

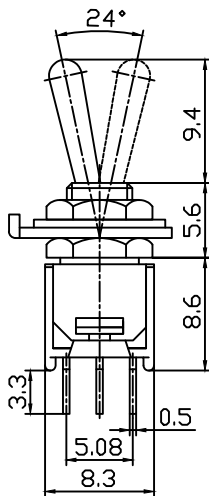

Mounting

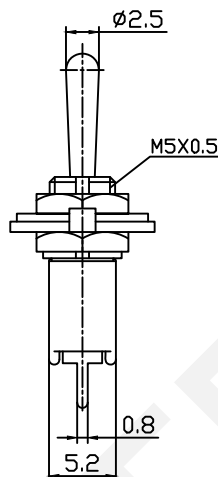

Circuitry

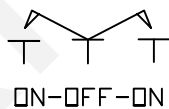
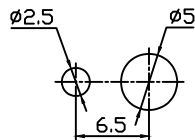

SPECIFICATIONS:

Rating: 3A 125VAC; 1.5A 250VAC
 Contact Resistance: 20mΩ max
 Insulation Resistance: 500V DC 1000MΩ Min
 Dielectric Strength: 1000V AC 1 Minute
 Operating Temperature: -25°C +85°C
 Electrical Life :10,000 Cycles

ORDER INFORMATION

RHTGYMS-1 03-A 2

Toggle Switch Series
 POLES: 1=Single Pole
 CIRCUIT: 03=ON-OFF-ON
 Handle Type: A=Standard
 Terminal Type: 2=Pc Terminal

RHTECP NINGBO RHT ELECTRONIC CO.,LTD

UNITS:mm	SHEET SIZE: A4		SCALE:---	DRWN BY PAN
0~3	3~18	18~50	50~120	CHK'D BY FENG
±0.12	±0.15	±0.3	±0.5	APPR BY ZHAN

Sub-Miniature Toggle Switch

THIRD ANGLE PROJECTION

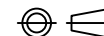

RHTGYMS-103-A2